

Princeton Fire Department

TYPE 1 2019 Ford "F-450" w/ 4WD AMBULANCE SPECIFICATION

INDEX - Alphabetical

Official specs – Version 3.3

Bidder requirements and Introduction

-1-

3.7.0 110 VOLT AC SYSTEM
3.6.0 12 VOLT DC OUTLETS

-2-

1.23.1 2WAY RADIO POWER PROVISIONS
5.4.0 2WAY REMOTE RADIO HEAD POWER PROVISIONS, PATIENT COMPT

-A-

1.13.0 ALTERNATORS
21.3.0 AMD MEMBERSHIP
19.3.0 ANTENNA PRE-WIRE
6.1.0 AUTO – EJECT OUTLET
1.3.0 AUXILIARY POWERTRAIN CONTROL (APC)
1.9.0 AXLE, REAR

-B-

7.1.0 BACK-UP CAMERA
1.12.0 BATTERIES
16.0 BODY FINISH
1.7.0 BRAKES
8.5.2 BULKHEAD CABINETS
14.3.0 BUMPER, REAR STEP

-C-

8.2.0 CABINETS, INTERIOR
8.3.0 CABINETS, LEFT WALL
1.0.0 CHASSIS
1.25.0 CHASSIS TOW HOOKS, FRONT & REAR
12.1.0 CLIMATE CONTROL
4.1.0 CLOCK, PATIENT COMPARTMENT
1.18.0 COOLING SYSTEM, ENGINE
10.2.0 COT MOUNT
1.24.0 CUSTOM CENTER CONSOLE, CHASSIS CAB

-D-

19.1.0 DECALS, NO SMOKING & OXYGEN EQUIPPED
17.1.0 DECALS, STAR-OF-LIFE
2.1.0 DIMENSIONS, EXTERIOR
2.2.0 DIMENSIONS, INTERIOR
7.2.0 DIRECTIONAL ARROW STICK
14.4.0 DOOR STEP, SIDE
2.8.0 DOORS
2.8.21 DOOR SWITCHING

-E-

3.1.0 ELECTRICAL SERVICE PANEL
3.2.0 ELECTRICAL SERVICE PANEL ACCESS
3.0.0 ELECTRICAL SYSTEM
3.5.0 ELECTRICAL WIRING
1.2.0 ENGINE
14.0 EXTERIOR BODY
15.0.0 EXTERIOR COMPARTMENT CONFIGURATION
2.7.0 EXTERIOR COMPARTMENT CONSTRUCTION

-F-

8.1.0 FLOOR, PATIENT COMPARTMENT
2.6.0 FLOOR SUB-STRUCTURE
21.5.0 FORD POOL PROGRAM
21.2.0 FORD QVM PROGRAM
1.10.0 FUEL TANK

-G-

1.4.0 GAUGES AND METERS
2.3.0 GENERAL CONSTRUCTION
1.26.0 GLOVE BOX HOLDER - CAB
9.5.1 GRAB HANDLES, DOORS
9.4.0 GRAB RAIL, OVERHEAD

-H-

9.2.0 HEADLINER
1.17.0 HEATER AND AIR CONDITIONER, CHASSIS

-I-

11.1.0 INSULATION
6.2.0 INVERTER / CHARGER / CONDITIONER
19.2.0 I.V. HOLDERS

-K-

21.1.0 KKK-A-1822-F CERTIFICATION

-L-

2.9.0 LICENSE PLATE HOLDER
3.9.3 LIGHTING, DOT
3.8.0 LIGHTING, EMERGENCY
3.1.5 LIGHTS, PATIENT COMPARTMENT
3.3.0 LOAD MANAGEMENT SYSTEM
5.2.0 LOW VOLTAGE ALARM

-M-

1.19.0 MIRRORS, OUTSIDE
1.22.0 MISCELLANEOUS CHASSIS ITEMS
19.0 MISCELLANEOUS EQUIPMENT
2.0 MODULE CONVERSION

-O-

15.1.0 OXYGEN COMPARTMENT
13.0.0 OXYGEN OUTLETS
OXYGEN SOLENOID

-P-

16.1.0 PAINTING PROCEEDURE
9.3.0 PANELING, INTERIOR
8.0 PATIENT COMPARTMENT
10.1.0 PATIENT COT / SPARE COT
18.0 PAYLOAD
18.1.0 PAYLOAD
22.0.0 PRE-DELIVERY INSPECTION

-R-

14.1.0 REAR WHEEL WELL TRIM
21.0 REQUIREMENTS OF THE MANUFACTURER
21.4.0 REMOUNTING AND REFURBISHING
2.4.0 ROOF
14.2.0 RUB RAILS
1.21.0 RUNNING BOARDS AND MUD FLAPS
1.23.0 REMOTE ENTRY

-S-

3.9.0	SCENE LIGHTS
15.3.0	SCBA / TURN-OUT GEAR COMPARTMENT
8.6.1.2	SEAT, CPR
8.6.0	SEAT, EMT/ATTENDANT
1.16.0	SEATS, DRIVER'S COMPARTMENT
3.4.0	SEQUENTIAL SWITCHING
8.5.6	SHARPS CONTAINER
2.5.0	SIDE WALLS
3.1.3	SIREN AND SPEAKERS
3.1.4	SPOTLIGHT
1.5.0	SPRINGS, AXLE RATINGS & SHOCKS
8.5.4	SQUAD BENCH
8.5.3	SQUAD BENCH CABINETS
9.6.0	STAINLESS STEEL SIDE WALL
1.6.0	STEERING
14.5.0	STONE SHIELDS
4.2.0	SUCTION - ON BOARD
5.1.0	SWITCH CONSOLE, DRIVER'S
5.3.0	SWITCH CONSOLE, PATIENT COMPARTMENT

-T-

23.0.0	TRADE-IN AMBULANCE
1.8.0	TRANSMISSION
1.20.0	TRIM PACKAGE, CAB

-U-

9.1.0	UPHOLSTERY
3.6.1	USB POWER OUTLET

-V-

1.1.0	VEHICLE AND WHEEL BASE
4.3.0	VENTILATION

-W-

20.0	WARRANTY
1.11	WHEELS AND TIRES
1.14.0	WINDOWS, CAB
1.15.0	WINDSHIELD WIPERS
19.4.0	WIRING SCHEMATICS
20.1.0	WARRANTY

Appendices

Bidder Requirements and Project Briefing

Introduction

On Wednesday, June 26th, 2019 – The Princeton Fire Department was advised that the Illinois Office of the State Fire Marshal Revolving Ambulance loan was approved. The loan package made provisions to purchase a new ambulance to replace an aged unit with increasing repair costs.

Bidder / Vendor Information

The specs in the attached pages are based on a **CUSTOM BUILT** ambulance. The specs consist of specific dimensions and requirements vital to the needs and operation of the customer. Manufacturers' proposed bids that only offer mass produced or "cookie-cutter" stream-lined produced ambulances with limited options will not be accepted.

Safety is first priority of the customer. Safety shall supercede any / or all items of the following specs. While it is understood by the customer that the attached specs may curtail to a specific manufacturer's materials or manufacturing process, the customer is requiring that the following bidding policy will be adhered to by all bidders:

Specified line items that are clearly marked **NO EXCEPTIONS** must be bid exactly as specified. No exceptions or deviations will be allowed without the expressed written consent of the customer.

Specified line items that are clearly marked **BIDDER EXEMPTION** must be bid with the quality of materials and/or construction craftsmanship that are equal to or exceeding those in the customer's specs. Any deviations to BIDDER EXEMPTION in the customer's bid specs must be clearly noted accordingly in the bidder's bid package.

Vehicle as-built documentation regarding the materials and / or craftsmanship, must be available by the bidder to support the bid as proposed upon reasonable request of the customer. The manufacturer and/or bidder must warranty the aforementioned materials and craftsmanship for no less than (1) calendar year.

Bidding Timeframe

All bids shall be presented in a three (3) ring binder and shall be labeled "Princeton Fire Department – 2019 Ambulance". Included in the bidder's spec package shall be a clearly stated "Order to Delivery" timeframe.

Bids due to customer: FRIDAY, SEPTEMBER 13th, 2019 at 8:30AM.

Bids are to be sent to:

Princeton Fire Department
Re: 2019 Ambulance Bids
2 S. Main St.
Princeton, IL 61356

FAXED OR EMAILED BID PROPOSALS ARE NOT ALLOWED

Purchaser Rights

The purchaser reserves the right to reject any or all bids due and accept that proposal which in their opinion is the most advantageous from a standpoint of design, maintenance, service, features and cost.

TYPE I 2019 Ford F-450 w/ 4WD
AMBULANCE SPECIFICATIONS

1.0.0 CHASSIS

1.1.0 **VEHICLE AND WHEEL BASE – NO EXCEPTIONS**

2019 Ford F-450 Super Duty XLT chassis with 4 wheel drive, skid plate under transfer case and dual rear wheels, 193 inch wheel base, 108 inch cab to axle, Ford Ambulance prep package.

NO EXCEPTIONS COMPLY? YES ____ NO ____

1.2.0 **ENGINE – NO EXCEPTIONS**

Ford 6.7-liter Power Stroke Turbo Charged V-8 Diesel with OEM engine block heater.

NO EXCEPTIONS COMPLY? YES ____ NO ____

1.3.0 **AUXILIARY POWERTRAIN CONTROL (APC) – NO EXCEPTIONS**

The Ford OEM APC module shall be standard. The module will be mounted in the front switch console. The APC Module is to be programmed in the “Charge Protection” mode. When the vehicle is in park, service brake disengaged and the parking brake is set, the APC module shall electronically adjust the engine idle (up or down) to maintain proper electrical system voltage.

NO EXCEPTIONS COMPLY? YES ____ NO ____

1.4.0 **GAUGES AND METERS – NO EXCEPTIONS**

Speedometer, odometer, fuel gauge, temperature, oil pressure, digital voltmeter, engine hour meter.

NO EXCEPTIONS COMPLY? YES ____ NO ____

1.5.0 **SPRINGS, AXLES, RATINGS, & SHOCKS – NO EXCEPTIONS**

Maximum GVWR – 16,500 lbs. GVWR

Front: Monobeam with coil springs, shock absorbers and stabilizer bar.

Rear: Non independent live axle with leaf springs and stabilizer bar.

A Liquid Spring suspension system shall be installed by Authorized Factory Trained Technicians and installers and shall comply with the allowable KKK-1822 compliant load height. A suspension dump cancel switch shall be installed inside the patient compartment on the inside of the passenger side rear door.

An “air-ride” suspension system is prohibited.

NO EXCEPTIONS COMPLY? YES ____ NO ____

1.6.0 **STEERING – NO EXCEPTIONS**

Power steering with tilt wheel and cruise control.

NO EXCEPTIONS COMPLY? YES ____ NO ____

1.7.0 **BRAKES – NO EXCEPTIONS**

Heavy duty, hydro-boost assisted type, 4-wheel anti-lock disc brake system.

NO EXCEPTIONS COMPLY? YES _____ NO _____

1.8.0 **TRANSMISSION – NO EXCEPTIONS**

Torqueshift™ heavy duty 6-speed Select Shift transmission with external oil cooler.

NO EXCEPTIONS COMPLY? YES _____ NO _____

1.9.0 **AXLE, REAR – NO EXCEPTIONS**

4.10gear ratio w/ limited slip axle.

NO EXCEPTIONS COMPLY? YES _____ NO _____

1.10.0 **FUELTANK – NO EXCEPTIONS**

Single tank w/ 40-gallon capacity.

NO EXCEPTIONS COMPLY? YES _____ NO _____

1.11 **WHEELS AND TIRES – NO EXCEPTIONS**

Seven (7) LT 225/70RX19.5G Steel Belted Radial tires, BSW all season tread. The spare tire shall be shipped loose. Stainless steel wheel inserts with valve stem extensions will be provided. The valve stem extensions are to be steel braided lines that are held in place with stainless steel brackets. These brackets are to be located in such a way as to provide easy access to both the inside and outside rear tires valve stems for the checking of tire pressure and for the addition of air when required.

NO EXCEPTIONS COMPLY? YES _____ NO _____

1.12.0 **BATTERIES – NO EXCEPTIONS**

Two 750 CCA mounted in the engine compartment and wired parallel in OEM configuration that complies with Ford QVM and KKK-A-1822-F requirements. Batteries will be wired so that both will always be used for starting and controlled by a power cut off switch. The Ford ignition key activates the cut off switch. Power can be provided to the module without the engine running by turning the ignition key to accessory position.

NO EXCEPTIONS COMPLY? YES _____ NO _____

1.13.0 **ALTERNATORS – NO EXCEPTIONS**

Dual Ford OEM alternators with internal regulators. One 200 amp alternator and one 150 amp alternator for a combined for a total of 350 amps

NO EXCEPTIONS COMPLY? YES _____ NO _____

1.14.0 **WINDOWS, CAB – NO EXCEPTIONS**

Safety glass is installed in all exterior windows. Ford OEM power operated windows.

NO EXCEPTIONS COMPLY? YES _____ NO _____

1.15.0 WINDSHIELD WIPERS – NO EXCEPTIONS

Two speed electric, with washer and adjustable intermittent cycle.

NO EXCEPTIONS COMPLY? YES ____ NO ____

1.16.0 SEATS, DRIVER'S COMPARTMENT – NO EXCEPTIONS

Deluxe cloth OEM High Back Captains Chairs, seat belts and shoulder harnesses.

The Ford OEM cab seats must be the seats installed and shipped with the chassis by Ford and have the correct Ford prescribed serial number. The Ford OEM seat pedestals shall be located in the mounting location as determined by Ford. Any changing of the Ford OEM Seats, mounting pedestals or location thereof is absolutely prohibited.

NO EXCEPTIONS COMPLY? YES ____ NO ____

1.17.0 HEATER AND AIR CONDITIONER – NO EXCEPTIONS

OEM heavy duty, high output.

NO EXCEPTIONS COMPLY? YES ____ NO ____

1.18.0 COOLING SYSTEM, ENGINE – NO EXCEPTIONS

Heavy-duty liquid system using a 50/50 mix of permanent type antifreeze and water for protection to -40 Fahrenheit.

NO EXCEPTIONS COMPLY? YES ____ NO ____

1.19.0 MIRRORS, OUTSIDE - NO EXCEPTIONS

OEM heated mirrors with power adjustment and built-in 2" x 6" convex mirrors, dual direction breakaway mounting arms with telescoping width adjustment.

NO EXCEPTIONS COMPLY? YES ____ NO ____

1.20.0 TRIM PACKAGE, CAB – NO EXCEPTIONS

XLT Trim Package; full stainless steel wheel simulators, chrome front bumper and grill. Color keyed door trim with map pockets, rubber floor mat, padded sunvisors, courtesy and dual dome lights, a minimum AM/FM Stereo Radio & Clock w/ dual cab speakers. Power door locks, cruise control, tilt steering wheel, and power adjustable brake and accelerator pedals.

NO EXCEPTIONS COMPLY? YES ____ NO ____

1.21.0 RUNNING BOARDS AND MUD FLAPS – NO EXCEPTIONS

Heavy-duty aluminum Diamond Plate running boards will be installed from the back of the front wheel opening to the front of the module box. They will include mudguards to protect the chassis and module. Rubber mud flaps will be installed behind the dual rear wheels and shall have the Module Manufacturers logo on the flaps.

NO EXCEPTIONS COMPLY? YES ____ NO ____

1.22.0 MISC. CHASSIS ITEMS – NO EXCEPTIONS

Jewel effect day time running headlights, dual pitch horn, reduced sound level exhaust, OEM standard undercoating, step-well pad and factory supplied jack and tire tools, dual air bags.

NO EXCEPTIONS COMPLY? YES ____ NO ____

1.23.0 REMOTE ENTRY – NO EXCEPTIONS

Remote Entry & anti theft with two key FOBs shall be included.

NO EXCEPTIONS COMPLY? YES _____ NO _____

1.23.1 2WAY RADIO POWER PROVISIONS – NO EXCEPTIONS

A 30 amp resettable breaker with a minimum 10 gauge copper stranded cable shall be supplied. A chassis ground cable consisting of a minimum 10 gauge copper stranded cable shall be supplied. This dedicated circuit shall be wired ignition hot and shall be ran to the main electrical compartment within the module with approximately 36” of excess cable. The ends of these cables shall be crimp terminated.

NO EXCEPTIONS COMPLY? YES _____ NO _____

1.24.0 CUSTOM CENTER CONSOLE – BIDDER EXEMPTION

A center console shall be fabricated from the cab dash to the inside back of the cab in between the driver and passenger seats. This console will make provisions for vehicle multiplex control panel, emergency lighting, eQ2b siren control and directional control. This console shall also make provisions for removable vertical dividers behind the controls area for miscellaneous items. There will be a padded “flip-up” style armrest covering these dividers. (See 1.26.0)

BIDDER EXEMPTION COMPLY? YES _____ NO _____

1.25.0 CHASSIS FRONT AND REAR TOW HOOKS – NO EXCEPTIONS

The chassis shall be equipped with DOT approved tow hooks bolted to the frame of both the front and rear of the vehicle.

NO EXCEPTIONS COMPLY? YES _____ NO _____

1.26.0 GLOVE BOX HOLDER (CAB) – BIDDER EXEMPTION

A glove box holder capable of holding two (2) non-latex glove boxes shall be innovatively located behind or towards the rear of the center console, between the seats. This glove box holder shall not interfere with the motion of the armrest or crew operations and shall provide easy deployment of the crews gloves. (See 1.24.0)

BIDDER EXEMPTION COMPLY? YES _____ NO _____

2.0 MODULE CONVERSION

2.1.0 DIMENSIONS, EXTERIOR – BIDDER EXEMPTION

*Note: The Overall exterior dimensions of the module listed below are considered **BIDDER EXEMPTION**. The actual exterior compartment dimensions shall be bid as close to customer specs and drawings as possible. It is understood by the customer that there may be some measurement variances by the manufacturer.

Overall vehicle length	304.0 inches
Overall vehicle height	113.5 inches
Overall module body length	172.0 inches
Overall module body height	95.0 inches
Overall module body width	96.0 inches

BIDDER EXEMPTION COMPLY? YES _____ NO _____

2.2.0 DIMENSIONS, INTERIOR – BIDDER EXEMPTION

*Note: The overall interior dimensions listed below are considered **BIDDER EXEMPTION**. The actual interior individual compartment dimensions shall be bid as close to customer specs and drawings as possible. It is understood by the customer that there may be some measurement variances by the manufacturer. The “Height floor to ceiling” spec shall be considered **NO EXCEPTION** as it a vital aspect of crew operations.

Length forward door to rear door	166.75 inches
Width interior wall to wall	92.0 inches
Width of aisle	49.0 inches
Height floor to ceiling (NO EXCEPTION)	74.0 inches
Loading height	34.5 inches

(Meets KKK and NFPA requirements)

BIDDER EXEMPTION COMPLY? YES _____ NO _____

2.3.0 GENERAL CONSTRUCTION – BIDDER EXEMPTION

2.3.1 The entire body will be a welded and **SEAMLESS** one-piece body. The entire perimeter and around all openings of the body shall be fully welded and ground smooth thus eliminating any joints or seams. The use of tongue and groove method of construction that requires the use of a seam sealer is not acceptable. This is to prevent the cracking of paint at these areas resulting in a buildup of road dirt and grime and the eventual development of corrosion along the tongue and groove seams.

BIDDER EXEMPTION COMPLY? YES _____ NO _____

2.3.2 The aluminum skin, the roof and side panels, shall be permanently fastened to the framework using Lord 406/19 Acrylic Adhesive. Adhesive is applied to the sidewall skin to prevent warp age, oil canning and metal deflection associated with the welding of the sidewall skin to the structural framework. The use of double back adhesive tape is prohibited to eliminate the possibility of the adhesive tape failing to maintain a bond to the external skin.

BIDDER EXEMPTION COMPLY? YES _____ NO _____

2.3.3 The body wall skin shall be of prime commercial quality .125" thick 3003 H14 corrosion resistant aluminum. All side and roof panels shall be .125" thick. The use of side and roof panels that are of a lesser thickness is strictly prohibited.

BIDDER EXEMPTION COMPLY? YES _____ NO _____

2.3.4 The roof panel shall be a single sheet of aluminum. Covering the roof of the exterior body with sectional pieces of aluminum panels is prohibited. This is to eliminate the necessity for joints or seams where these panels join.

BIDDER EXEMPTION COMPLY? YES _____ NO _____

2.3.5 The wall and roof support framework shall be .125" 6061-T6 extruded aluminum box beams and extrusions spaced on 12" centers or less. There shall be no frame members spaced at a distance in excess of 12". The roof support framework shall additionally include .125" 6061-T6 extruded 1" x 2" aluminum box beams running the full length of the roof. The frame and skin shall be fully welded with no rivets.

BIDDER EXEMPTION COMPLY? YES _____ NO _____

2.3.6 The exterior of the body will be finished smooth with 45-degree SEAMLESS beveled extruded corners presenting a modern and dynamic appearance. The outer wall thickness of the extruded corners shall be .250" to provide additional protection at all corners. The body will be designed and built to provide impact and penetration resistance, with appropriate channel reinforcing to assure rigidity.

BIDDER EXEMPTION COMPLY? YES _____ NO _____

2.3.7 All parts of the body and attachments will be fastened together with rust resistant fasteners in a manner that will preclude loosening of any bolts and screws, and the cracking of welded joints. The exterior body panels will be made of not less than 0.125" thick metal and be reinforced at all points where equipment will be attached.

BIDDER EXEMPTION COMPLY? YES _____ NO _____

2.3.8 The body will be a bolted and welded structure. Welding will not however, be employed in the assembly of the body in a manner that will prevent the ready removal of any component part for service or repair.

BIDDER EXEMPTION COMPLY? YES _____ NO _____

2.3.9 In the assembly of the body, areas where steel is in contact with aluminum, there shall be butyl rubber isolator pads installed. This pad provides corrosion and water resistance.

BIDDER EXEMPTION COMPLY? YES _____ NO _____

2.3.9.1 All fasteners, bolts, screws, etc used in the assembly of the body and all attachments shall be coated with the "ECK" brand corrosive protectant. Additionally, all exterior door hinges, both entry and compartment, are to be coated with "ECK" protectant prior to the installation of the door. This "ECK" coating is to be used in lieu of a gasket material behind the hinge to prevent the problems of gasket retention and deterioration.

BIDDER EXEMPTION COMPLY? YES ____ NO ____

2.3.9.2 Stainless steel drip plates shall be affixed to the drivers side outside body panel below both the diesel and DEF fill ports to minimize body corrosion from any fuel spillage.

BIDDER EXEMPTION COMPLY? YES ____ NO ____

2.4.0 **ROOF – BIDDER EXEMPTION**

2.4.1 The roof surface shall be **SEAMLESS** and **CROWNED** and of **ONE PIECE** of .125" aluminum (3003-H14). The use of any type of sealer or caulking material is strictly forbidden. There shall be no lip or protrusion on the roof that could result in the entrapment of any water or moisture.

BIDDER EXEMPTION COMPLY? YES ____ NO ____

2.4.2 The perimeter of the roof shall be constructed of 45-degree **SEAMLESS** beveled extrusions that eliminate any lip or protrusion providing a smooth finish. The outer wall thickness of the roof perimeter extrusions shall be .250" to provide additional protection at all perimeter corners.

BIDDER EXEMPTION COMPLY? YES ____ NO ____

2.4.3 The roof under structure will be fabricated from extruded aluminum box beams (6061-T6). The under structure will be constructed by welding 1" x 2" x .125" box beams lengthwise and by welding 2" x 2" x .125" box beams, spaced on 12" centers or less, crossways forming a cross sectional grid roof support framework. The complete roof will be treated with a sound-deadening barrier. The roof panel shall be fully perimeter welded and adhesive bonded to the roof under structure with Lord 46/19 Acrylic Adhesive. The use of skip or intermittent welding of the roof perimeter is unacceptable.

BIDDER EXEMPTION COMPLY? YES ____ NO ____

2.5.0 **SIDE WALLS – BIDDER EXEMPTION**

2.5.1 The body sidewall skin shall be constructed of .125" aluminum (3003 H14). The sidewall under structure will be fabricated by welding 2" x 2" x .125" extruded aluminum box beams vertically, spaced no further than on 12" centers. The vertical tubing will join and be welded to roof supports (2" x 2" x .125" extruded aluminum box beams) to form an interlocking grid between the sidewall and the ceiling. The complete sides will be treated with a sound-deadening barrier. The body sidewall skin shall be fully welded around the entire perimeter and all body openings and adhesive bonded to the sidewall frame work with Lord 406/19 Acrylic Adhesive.

BIDDER EXEMPTION COMPLY? YES ____ NO ____

2.5.2 All body openings shall be seamless. Body openings framed with tongue and groove style extrusions requiring the use of seam sealer will not be acceptable.

BIDDER EXEMPTION COMPLY? YES _____ NO _____

2.6.0 FLOOR SUB-STRUCTURE – BIDDER EXEMPTION

2.6.1 The floor shall be at the lowest level permitted but not more than 35 inches from the ground. ***NOTE: NO EXCEPTION** Floor sub-structure shall allow for proper installation and operation of the Liquid Spring suspension system.

BIDDER EXEMPTION COMPLY? YES _____ NO _____

2.6.2 The floor sub-structure shall consist of two (2) 1/4" walls 2" x 2" aluminum tubes running at the outer edge for the full length of the floor and the chassis frame rails. There shall then be sixteen (16) 1 1/2" x 1 1/2" x 1/4" walls 1 1/2" x 2" aluminum tubes running the width of the floor and fully welded to the outer tubes. This sub-structure frame is to mount on top of the Chassis frame rails via the 12 OEM Pucks. 2 Full-Length Plates measuring 3/4" x 6" shall be welded to the under side of the 1 1/2 x 1 1/2 tubes, one left and one right. The outer edges of these plates shall be welded to the 2 x 2 primary box beams. These plates shall be bolted, via OEM rubber mounts, to gusseted steel brackets bolted to the OEM frame. There shall be twelve (12) rubber mounts attaching the body to the frame.

BIDDER EXEMPTION COMPLY? YES _____ NO _____

2.7.0 EXTERIOR COMPARTMENT CONSTRUCTION – BIDDER EXEMPTION

2.7.1 Compartments provided on the unit will be constructed as follows: The compartment floor will be fabricated of .125 diamond plate aluminum (3003-H14) and the ceiling and bulkheads of .100 diamond plate aluminum (3003-H14). All compartment floors will be reinforced with two 1x2 aluminum bars on the underside of the floor.

BIDDER EXEMPTION COMPLY? YES _____ NO _____

2.7.2 All exterior compartments will be sweep out style to provide for ease of cleaning. Drain holes are not desirable. All exterior compartments will be vented to provide for the displacement of air when closing doors. Vent louvers shall be installed on the vertical walls of the exterior compartments.

BIDDER EXEMPTION COMPLY? YES _____ NO _____

2.7.3 All exterior compartments shall be LED lighted when the compartment door is opened. Compartment lights will be flush mounted with wiring routed through the body eliminating any exposed wiring.

BIDDER EXEMPTION COMPLY? YES _____ NO _____

2.7.4 All exterior compartment shelving shall be "Pan" style aluminum shelves mounted on two (2) sets of uni-strut tracks at each end of the shelf providing infinite adjustment. Rubber matting is to be installed on the topside of all shelving.

BIDDER EXEMPTION COMPLY? YES _____ NO _____

2.8.0 **DOORS – BIDDER EXEMPTION**

2.8.1 The corner of each door frame shall be ¼” Cast Aluminum inserted & welded to horizontal & vertical extrusions. This Cast part shall ensure superior strength as well as uniform fit & finish.

BIDDER EXEMPTION COMPLY? YES _____ NO _____

2.8.2 The door(s) of each compartment will be flush type (being on the level with adjacent body surface) and of **PAN FORMED / EXTRUSION DOUBLE BREAK** construction. The weather seal is to be mounted on the outer flange of the door with the latches and strikers mounted on the extruded second break inside the door opening. This door design eliminates exposure of the latches to the elements and prevents moisture from corroding the latch mechanisms.

BIDDER EXEMPTION COMPLY? YES _____ NO _____

2.8.3 All doors shall be constructed of .125 aluminum and 2 ½” thick.

BIDDER EXEMPTION COMPLY? YES _____ NO _____

2.8.4 The inner panel on all exterior compartment and entry doors will be fastened to the extruded door-frame and recessed into the door frame extrusion for a flush finish. Surface mounting of any interior door panels is not allowed. All fasteners used for the mounting of the interior panels are to have a rubber grommet affixed to the underside of the screw head to prevent the fastener screws from loosening and backing out of the extrusion. The interior door panels shall be readily removable for access to the interior of the door and the latching mechanism.

BIDDER EXEMPTION COMPLY? YES _____ NO _____

2.8.5 All doors shall be reinforced and cross-braced inside for increased strength allowing for the mounting of equipment on the door.

BIDDER EXEMPTION COMPLY? YES _____ NO _____

2.8.6 In order to facilitate adjustment and routine maintenance of door linkage rods and latches, all patient compartment entry doors shall have access ports. There is to be an access port above and one below each interior entry door handle of sufficient size to allow for the adjustment of the door linkage rods. All ports are to be covered with a friction type “plug-in” plastic cover that is readily removable.

BIDDER EXEMPTION COMPLY? YES _____ NO _____

2.8.9 The door latch assembly of each compartment will be an Eberhard Grabber 21100 series, two (2)-point slam lock (206 rotary latch), of stainless steel construction. Door latch assemblies shall be “blind mounted” eliminating any exposed mounting hardware on the exterior side of the latches. There is to be a rubber gasket between the exterior stainless steel latch assembly and the aluminum door to ensure the isolation of the two dissimilar metals.

BIDDER EXEMPTION COMPLY? YES _____ NO _____

2.8.8 The door linkage rods' connecting the door handles and the rotary latches are to be 5/32 steel rods threaded on the turn buckle end. They shall be straight direct pull rods with no bends built into the rods allowed. Adjustments to the entry door linkage rods are to be provided by a turnbuckle located above and below and adjacent to each interior door handle.

BIDDER EXEMPTION COMPLY? YES _____ NO _____

2.8.9 All exterior doors are to be lockable via an "automotive style" lock with all compartment and patient compartment entry doors being keyed alike. The key shall be double sided for ease of insertion into the lock. The curb-side and rear patient compartment doors shall have electric locks and shall be hardwired to the chassis power door locks and shall operate as an integrated unit.

BIDDER EXEMPTION COMPLY? YES _____ NO _____

2.8.10 Door strikers shall be installed on the vertical compartment flanges, with the exception of double doors. There are to be two (2) pins per door, with the exception of the battery compartment door. All striker pins shall be fully adjustable from the exposed side. They will be grade 8.0 cadmium plated steel strikers with a "captive nut" for adjustment and so located as not to interfere with the sweep-out design of the compartment itself.

BIDDER EXEMPTION COMPLY? YES _____ NO _____

2.8.11 All compartment and entry doors shall have one-piece Stainless Steel doorsill protectors that will cover both surfaces of the body opening.

BIDDER EXEMPTION COMPLY? YES _____ NO _____

2.8.12 Each compartment and entry door is to have a full width aluminum drip rail mounted above each door. All drip rails are to be attached using double back adhesive tape. The use of screws, rivets, or any other form of metal attachment is not acceptable.

BIDDER EXEMPTION COMPLY? YES _____ NO _____

2.8.13 All compartment doors will be equipped with a gas strut door stay that holds the door at 90 degrees to the body when open. All gas struts are to be mounted in such a way as to allow for easy access in the event that replacement or repair is required.

BIDDER EXEMPTION COMPLY? YES _____ NO _____

2.8.14 There shall be a "dampening" devise installed within each gas strut for the purpose of preventing the "shock" that can occur when a gas strut is fully extended.

BIDDER EXEMPTION COMPLY? YES _____ NO _____

2.8.15 Each compartment door will be mounted with a continuous stainless steel hinge with a minimum pin diameter of (.250). Hinge Pin diameter of less than (.250) is unacceptable to ensure the long-term performance of the hinge in this extreme use application.

BIDDER EXEMPTION COMPLY? YES _____ NO _____

2.8.16 Each compartment opening is to be sealed with full perimeter 5/8" wide by 1/2" thick hollow core wiper seal. The seal is to be mounted on the doorframe out board of the striker pins and the door latches. This seal insures that each compartment will be dust and waterproof and that the striker pins and door latches will remain dry and clean.

BIDDER EXEMPTION COMPLY? YES ____ NO ____

2.8.17 All exterior compartment and patient compartment entry doors shall be insulated with a single layer of R-14.5 reflectix insulation. Additionally there shall be a single layer of 2" polystyrene insulation installed in each door.

BIDDER EXEMPTION COMPLY? YES ____ NO ____

2.8.18 Rear patient compartment doors shall be equipped with Cast Products "Grabber" hold-open devices. Side patient compartment door shall be equipped with Gas Strut door opening device.

BIDDER EXEMPTION COMPLY? YES ____ NO ____

2.8.19 Rear and side patient compartment doors shall have dark tinted safety glass windows encased in extruded aluminum frames. Each rear door shall have an 18.5" x 17.5" fixed window. The side door shall have an 18.5" x 17.5" slide opening window with screen and window lock.

BIDDER EXEMPTION COMPLY? YES ____ NO ____

2.8.20 Right side entry door opening: 68"H X 30" W
Rear entry door opening (double door): 57"H X 48" W

BIDDER EXEMPTION COMPLY? YES ____ NO ____

2.8.21 DOOR SWITCHING

Magnetic Door Switches shall be installed to activate Door Open, Compartment Open, Dome and Scene Lights via a PC board.

BIDDER EXEMPTION COMPLY? YES ____ NO ____

2.9.0 LICENSE PLATE HOLDER – BIDDER EXEMPTION

Installed in the center of the rear kick plate above the rear step bumper there shall be a Cast Products license plate holder.

BIDDER EXEMPTION COMPLY? YES ____ NO ____

3.0 ELECTRICAL SYSTEM

3.1.0 ELECTRICAL SERVICE PANEL – NO EXCEPTION

3.1.1 All circuits shall be rated to carry at least 125% of its maximum load. Each circuit shall be protected by a manual reset circuit breaker.

NO EXCEPTION COMPLY? YES ____ NO ____

3.1.2 Circuit breakers and relays shall be mounted in plug-in, pull out sockets that are permanently mounted in a printed circuit board for durability, as well as weight and space savings. Relays should be a type that is readily accessible at any auto parts store. Circuit breakers shall be interchangeable with standard ATC automotive fuses so that system can be quickly returned to service.

NO EXCEPTION COMPLY? YES ____ NO ____

3.1.3 **SIREN AND SPEAKERS – NO EXCEPTIONS**

Siren shall be a Federal eQ2B Electronic siren and Dual Cast Products Siren Speakers shall be mounted outboard in the face of the Chrome Front Bumper, below the Headlights, in cast aluminum housings.

NO EXCEPTION COMPLY? YES ____ NO ____

3.1.4 **SPOTLIGHT – BIDDER EXEMPTION**

There shall be a "300,000 candle power" spotlight, with eight foot coiled cord and momentary switch, permanently wired into front console. A "Mic" style storage clip shall be provided.

BIDDER EXEMPTION COMPLY? YES ____ NO ____

3.1.5 **LIGHTS, PATIENT COMPARTMENT – BIDDER EXEMPTION**

3.1.5.1 NOTE: All patient compartment lighting shall be LED. **NO EXCEPTIONS**

NO EXCEPTIONS COMPLY? YES ____ NO ____

3.1.6 The ceiling headliner shall contain eight (8) Whelen High - Low intensity LED dome lights. The left and right banks of lights shall be switched separately. In addition, the left bank high mode can be switched from the drivers switch panel and will be activated by opening of the side or rear entry doors.

BIDDER EXEMPTION COMPLY? YES ____ NO ____

3.1.7 There shall be a "Rig Check-Out" timer switch installed in the right wall at the head of the squad bench. The timer switch will allow the forward most bank of Dome Lights to turn on even when the master switch is in the off position. **NOTE:** This spec can be altered by the bidder if the check-out feature is integrated into the multiplex system.

3.1.8 In addition, a 10" LED light shall be in the action area.

BIDDER EXEMPTION COMPLY? YES ____ NO ____

3.2.0 **ELECTRICAL SERVICE PANEL ACCESS – BIDDER EXEMPTION**

The electrical service panel shall be mounted behind the hinged action wall and shall be easily accessible by activating a single latch allowing the switch panel section to swing down.

BIDDER EXEMPTION COMPLY? YES ____ NO ____

3.3.0 **LOAD MANAGEMENT SYSTEM – NO EXCEPTION**

The distribution panel shall include a solid-state programmable load management system designed to sense when the charging system is not keeping up with the electrical demand. When this situation exists, the multiplex / load manager will automatically shut down warning lights, one at a time in a programmed sequence until the electrical load is being sustained without discharge. This system only functions when the unit is in park.

NO EXCEPTION COMPLY? YES ____ NO ____

3.4.0 **SEQUENTIAL SWITCHING – NO EXCEPTION**

A solid state Sequential Switching System shall be installed that will turn emergency lighting on/off in a staggered 1/2-second interval. This is designed to avoid dumping a sudden load on the alternator.

NO EXCEPTION COMPLY? YES ____ NO ____

3.5.0 **ELECTRICAL WIRING – NO EXCEPTION**

3.5.1 All the vehicle's electrical equipment shall be served by circuits separate and distinct from the chassis electrical system. All electrical wiring shall be run in grease, oil, heat and moisture resistant looming. Harnesses shall be fastened with vinyl-clad clamps and grouted at any area they contact a metal edge.

NO EXCEPTION COMPLY? YES ____ NO ____

3.5.2 Every load carrying wire shall be a minimum of 12 gauge, and shall be color-coded and heat embossed with its function every 4 to 6 inches.

NO EXCEPTION COMPLY? YES ____ NO ____

3.5.3 There shall be at least a six-inch service loop of wire at the point of attachment to each component. All electrical connections shall be machine crimped; the use of Scotch-locks is strictly prohibited.

NO EXCEPTION COMPLY? YES ____ NO ____

3.6.0 **12VDC / 5VDC OUTLETS – NO EXCEPTION**

There shall be two (2) Cigar style 12V DC outlets, one located in the action area, and one in the right front bulkhead ALS compartment.

NO EXCEPTION COMPLY? YES ____ NO ____

3.6.1 There shall be one (1) recessed 5VDC dual USB power outlet near the 12VDC outlet located in the action area.

NO EXCEPTION COMPLY? YES ____ NO ____

3.7.0 **110V AC SYSTEM – NO EXCEPTION**

3.7.1 *NOTE: This receptacle shall coincide with 6.1.0 and 6.2.0.

3.7.2 There shall be a weatherproof 110V- 125V male receptacle rated at 20 amps with a spring-loaded cover assembly located on the front left corner of the module body for incoming 110-volt power. This receptacle shall be labeled. It shall be wired through one 15-amp circuit breaker. The circuit shall include two (2) 110-volt interior receptacles, one located in the action wall area and one in the ALS area. Both outlets shall illuminate per KKK-A-1822-F.

NO EXCEPTION COMPLY? YES _____ NO _____

3.8.0 LIGHTING, EMERGENCY

3.8.1 NOTE: All emergency lighting shall be LED. **NO EXCEPTIONS**

NO EXCEPTION COMPLY? YES _____ NO _____

3.8.2 The unit shall be equipped with the following LED warning lights: **BIDDER EXEMPTION**

- 8) Whelen Series 9 x 7 red LED lights as follows:
 - 4) Facing forward
 - 2) Facing rearward
 - 2) Facing right
 - 2) Facing left
- 3) Whelen Series 9 x 7 clear LED light installed alternating with red LED lights forward.
 - 1) Whelen Series 9 x 7 amber LED light installed top center rearward.
 - 2) Whelen red LED lights mounted in the Front Fenders.
 - 2) Whelen Series 500 red LED's in Chrome Housings in the Grill.
 - 2) Whelen Series 500 clear LED's in Chrome Housings in the Grill.
 - 2) Whelen red LED lights mounted on each side of the module above the Rear Fenders.

BIDDER EXEMPTION COMPLY? YES _____ NO _____

3.8.3 Circuit shall have a dual mode switch. "Primary" shall flash all lights. "Secondary" shall flash top red & amber lights only.

BIDDER EXEMPTION COMPLY? YES _____ NO _____

3.9.0 SCENE LIGHTS – BIDDER EXEMPTION (unless otherwise stated)

3.9.1 NOTE: All scene lighting shall be LED. **NO EXCEPTIONS**

3.9.2 There shall be four (4) LED Whelen Series 9 x 7 with 13-degree tilt built into the lenses mounted two (2) lights on the left side and two (2) lights on the right side. There shall be two (2) LED Whelen Series 9 x 7 with 13-degree tilt built into the lenses mounted on the rear. A separate multiplex control on the driver's switch panel shall control each pair. In addition, the right side and rear scene lights shall activate when the right side or rear doors, respectfully, are open. The rear side scene lights shall activate when the vehicle is in reverse. Halogen lighting is not accepted.

BIDDER EXEMPTION COMPLY? YES _____ NO _____

3.9.3 **LIGHTING, DOT – BIDDER EXEMPTION**

The vehicle shall be equipped with jewel affect daytime running headlights and two amber park/turn lights on the front. The Module Body shall have at least 11 LED clearance lights with "each light having four (4) LED's and grounded via a ground wire". Each top front corner shall have amber lights mounted on the front and side of each corner. There shall be three red lights at the top rear center of the module. Each top rear corner shall have red lights mounted on the rear and side of each corner. There shall be three amber lights mounted on the center front of the cab roof.

BIDDER EXEMPTION COMPLY? YES ____ NO ____

3.9.3.1 There shall be (2) red Whelen 900 LED lights mounted between the rear turn signal lights and the red Whelen 900 LED lights on each side of the rear of the vehicle. These lights shall be activated with brake activation.

BIDDER EXEMPTION COMPLY? YES ____ NO ____

3.9.3.2 The rear of the module box shall have two Whelen 4" x 6" series amber LED arrow turn lights, two Whelen 4" x 6" series red LED tail/brake lights, two Whelen 4" x 6" series LED reverse lights. They will be mounted in chrome flanges on the modular body above the diamond plate in the above listed order top to bottom. Mounting of these lights shall be as far outboard on the rear of the module body as possible.

BIDDER EXEMPTION COMPLY? YES ____ NO ____

3.9.3.3 All lights shall be as per I.C.C. requirements.

BIDDER EXEMPTION COMPLY? YES ____ NO ____

4.1.0 **CLOCK, PATIENT COMPARTMENT – NO EXCEPTIONS**

A battery-powered clock with a sweep seconds hand shall be located above the rear patient entry doors and shall be visible from all seat locations. The clock shall be secured to prevent detachment from road vibrations and other movements.

NO EXCEPTIONS COMPLY? YES ____ NO ____

4.2.0 **SUCTION - ON BOARD – BIDDER EXEMPTION**

An SSCOR/Board On Board suction system with an Impact E-12 Suction Pump shall be provided and mounted on the back wall above the action area counter top just forward of the CPR Seat.

BIDDER EXEMPTION COMPLY? YES ____ NO ____

4.3.0 **VENTILATION – BIDDER EXEMPTION**

A 138-CFM exhaust fan shall be mounted near the ceiling in the left rear of the patient compartment and shall be activated by a switch on the action wall.

BIDDER EXEMPTION COMPLY? YES ____ NO ____

5.1.0 SWITCH CONSOLE, CAB – (SEE SPEC LINE ITEM 1.24.0) – BIDDER EXEMPTION

There shall be a multiplexed switch console mounted in the center of the cab floor between the seats in such a way as to not interfere with access to the dash yet easily accessible to the driver. The top of the console shall be easily removable to allow access for service. The control panel shall be esthetically appealing and incorporate modern controls and gauges as follows:

Including but not limited to:

- Master Switch
- Load Manager/Sequencer
- Primary/Secondary
- Siren/Horn
- Left Scene
- Rear Scene
- Right Scene
- Rear Dome Lights
- Back up Alarm Disable
- Silent Intercom Lights
- Door Ajar Light
- Compartment Open Light
- Voltmeter

BIDDER EXEMPTION COMPLY? YES _____ NO _____

5.2.0 LOW VOLTAGE ALARM – BIDDER EXEMPTION

A Low Voltage Alarm shall sound when voltage drops below 11.8 volts for more than 120 seconds.

BIDDER EXEMPTION COMPLY? YES _____ NO _____

5.3.0 CONTROL CONSOLE, PATIENT COMPARTMENT – BIDDER EXEMPTION

The following multiplexed controls shall be in the located patient compartment control panel, which shall be hinged for easy access to components. They shall be mounted at an angle facing the center of the cot and the squad bench.

Including but not limited to:

- Left Dome High/Low
- Right Dome High/Low
- Silent Intercom Switches
- Driver Buzzer
- Exhaust Fan
- Checkout Lights
- Thermostat Control for Heat/A.C.
- Heat/A.C. Fan Control, 3 speed.

BIDDER EXEMPTION COMPLY? YES _____ NO _____

5.3.1 All switches in front and rear panels shall be multiplexed and indicated by function, illuminate when activated and backlit for night visibility.

BIDDER EXEMPTION COMPLY? YES _____ NO _____

5.4.0 **2WAY REMOTE RADIO HEAD PROVISIONS, PATIENT COMPARTMENT – NO EXCEPTIONS**

A 12 gauge 12VDC+ wire shall be provided behind the switch console (5.3) for the remote radio head. This wire shall be ignition hot and shall be independent of module power disconnect switch. This wire shall have a 20 Amp resettable breaker. A 12 gauge chassis ground wire shall be provided behind the switch console (5.3.0) for the remote radio head.

NO EXCEPTIONS COMPLY? YES ____ NO ____

6.1.0 **AUTO-EJECT SHORELINE – NO EXCEPTIONS**

The Module shall be equipped with a Kussmall Auto Eject Shoreline Outlet. The outlet must be hardwired to the on-board inverter / charger / conditioner. The outlet must automatically eject the plug upon ignition start and shall be rated for a minimum 20 amps AC. The outlet shall be located near the driver's side front corner of the module and a minimum of 48" up from the bottom of the module.

NO EXCEPTIONS COMPLY? YES ____ NO ____

6.2.0 **INVERTER / CHARGER / CONDITIONER – NO EXCEPTIONS**

The vehicle shall be equipped with an on-board 12 VDC / 120VAC inverter / charger / conditioner. The unit shall be installed in a location that allows for ease of servicing and does no inhibit operations of the customer or other equipment. The unit must charge the chassis batteries while plugged into the shoreline and provide power to the module 120VAC outlets. The unit must automatically switch to battery inverter power when the vehicle is started and supply power to the module 120VAC outlets. The inverter must be independent of the module disconnect switch and shall power off with chassis' timer off function following turning the ignition key off.

NO EXCEPTIONS COMPLY? YES ____ NO ____

7.1.0 **BACK-UP CAMERA – NO EXCEPTIONS**

A color back-up camera shall be installed above the rear patient compartment doors on the outside of the module. The power to the camera shall be ignition-hot and the closed circuit monitor shall be installed in the cab area in place of the factory rear view mirror. This monitor shall not be exceedingly obstructive to the occupants in the cab of the vehicle.

NO EXCEPTIONS COMPLY? YES ____ NO ____

7.2.0 **DIRECTIONAL ARROW STICK – BIDDER EXEMPTION**

An amber / orange LED directional arrow stick shall be installed above the rear patient compartment doors on the rear of the vehicle. The control unit for the arrow stick shall be installed in the center console in the cab. The power to the arrow stick and controller shall be hardwired into the Master Warning On/Off toggle switch.

BIDDER EXEMPTION COMPLY? YES ____ NO ____

8.0 PATIENT COMPARTMENT

8.1.0 FLOOR, PATIENT COMPARTMENT – BIDDER EXEMPTION

The sub floor shall consist of .090" thick 3003 H14 corrosion resistant aluminum sealed watertight. Over the aluminum sub-floor there shall be a sheet of 3/4", 13 ply, exterior grade plywood that is caulked and sealed.

BIDDER EXEMPTION COMPLY? YES ____ NO ____

8.1.1 The floor is then to be covered with a single piece of commercial-grade, LON-PLATE non skid flooring which shall roll up the left wall and the squad bench approximately 3". Behind the linoleum at the base of the left wall and the squad bench, coving shall be installed providing a solid backing at the point of the bend in the floor. This coving shall run the full length of the left wall and the squad bench. Flooring shall be sealed at all edges to prevent water from seeping between the floor and cabinets. Color shall be LONCOIN II FLECKS Color: 150 Onyx or dark colored equivalent.

BIDDER EXEMPTION COMPLY? YES ____ NO ____

8.1.2 A formed 6 inch, full width stainless steel floor protection strip shall be installed forward of the rear patient compartment door seal. Additionally antiskid tape, 2 inch wide, is to be laid the full width just inside the rear entry doors over the floor protection strip.

BIDDER EXEMPTION COMPLY? YES ____ NO ____

8.2.0 CABINET'S, INTERIOR – BIDDER EXEMPTION

8.2.1 All interior cabinets shall be built using 3/4" cabinet grade, finished both sides, 7 ply, solid core, birch plywood. The use of plywood of any lesser quality or thickness is strictly prohibited.

BIDDER EXEMPTION COMPLY? YES ____ NO ____

8.2.2 All interior cabinets shall be constructed using wood screws. The use of staples or nails in the fastening of cabinet components is strictly prohibited.

BIDDER EXEMPTION COMPLY? YES ____ NO ____

8.2.3 Exposed cabinet surfaces, interior and exterior, are to be covered with "Wilsonart" laminate. All cabinets and counter tops shall be caulked and sealed. Cabinets shall incorporate 1-inch aluminum radius corners throughout and have generous padding to lessen the chance of injuries in the event of an accident. Sliding Plexiglas windows shall be 1/4" thick with full height extruded aluminum handles mounted in full perimeter slide track. Door catches shall be flush-mount slam-type positive latching.

BIDDER EXEMPTION COMPLY? YES ____ NO ____

8.3.0 CABINETS, LEFT WALL – BIDDER EXEMPTION (unless otherwise stated)

Individual cabinet dimensions shall be designed shall be bidded as close to customer specs and drawings as possible. It is understood by the customer that there may be some measurement variances by the manufacturer.

BIDDER EXEMPTION COMPLY? YES ____ NO ____

8.3.1 Cabinets shall have a one-piece molded Fiberglass countertop for the attendant in the action area. Storage cabinets shall be located in the left rear, above the CPR seat, and above the action area. The cabinet over the action area will have the same angle front to back as the cabinet

BIDDER EXEMPTION COMPLY? YES ____ NO ____

The action wall shall house the technician's console, two oxygen outlets, vacuum outlet, aspirator collection bottle, climate control thermostat and fan control, one 12-volt connection, one 5VDC dual-USB outlet and one lighted 110V duplex outlet. The upper action wall area, shall be hinged for ease of access.

BIDDER EXEMPTION COMPLY? YES ____ NO ____

8.5.2 **BULK HEAD CABINETS – BIDDER EXEMPTION (unless otherwise stated)**

8.5.2.1 Bulkhead cabinets shall be designed per drawings. Individual cabinet dimensions shall be bidded as close to customer specs and drawings as possible. It is understood by the customer that there may be some measurement variances by the manufacturer

BIDDER EXEMPTION COMPLY? YES ____ NO ____

8.5.2.2 The driver side cabinet shall incorporate a floor mounted climate control unit. Unit shall drain directly through the floor. Air in-take shall be at floor level, while output shall be ducted overhead, across the bulkhead cabinets. The return air shall be filtered. Directly above the climate control unit shall be a storage area.

BIDDER EXEMPTION COMPLY? YES ____ NO ____

8.5.2.3 A horizontal cabinet shall be located above the walk-thru at ceiling level. The right side shall have a locking drug box at ceiling level and inside/outside access cabinets below all the way to floor level with two adjustable shelves, and two solid full-length doors. The inside/outside cabinet shall be lighted at each shelf level with recessed lighting. The face of the overhead bulkhead cabinet doors shall be padded.

BIDDER EXEMPTION COMPLY? YES ____ NO ____

8.5.2.4 The bulkhead shall incorporate a pass through Plexiglas sliding window from the rear patient compartment to the front cab. This window shall be sealed and weather proof via a flexible rubber boot connection between the cab and the modular body.

BIDDER EXEMPTION COMPLY? YES ____ NO ____

8.5.3 **SQUAD BENCH CABINETS – BIDDER EXEMPTION**

Two cabinets shall be mounted at the ceiling level directly over the entire length of the squad bench. They shall have “flip-up” style Plexiglas doors. There must be a minimum of 43” from the bottom of these cabinets to the top of the squad bench.

BIDDER EXEMPTION COMPLY? YES ____ NO ____

8.5.4 **SQUAD BENCH – BIDDER EXEMPTION**

The squad bench base shall be constructed of .075" gauge stainless steel for strength and ruggedness". The lid shall be split into two sections. Each lid will have a gas strut hold open device and paddle style latches. The interior shall be lined with white Wilsonart laminate.

BIDDER EXEMPTION COMPLY? YES ____ NO ____

8.5.5 There shall be portable O2 storage mounted recessed in the squad bench next to the steps. This storage shall provide (2) portable O2 bottle storage slots.

NO EXCEPTIONS COMPLY? YES ____ NO ____

8.5.6 There shall be a removable wide "A" bar mounted on the forward end of the squad bench. This "A" bar shall be capable of holding a sharps container and a general trash container. Drawings for this "A" bar are on the "Passenger Interior Wall" and "Interior Floor". The sharps container and trash container shall be included in this spec.

NO EXCEPTIONS COMPLY? YES ____ NO ____

8.6.0 **SEAT, EMT / ATTENDANT – BIDDER EXEMPTION**

An attendant seat shall be located at the head of the primary cot. It shall be a high back deluxe seamless vinyl captain's chair mounted on a base as approved by the seat manufacturer. A seat belt shall be provided for attendant safety.

BIDDER EXEMPTION COMPLY? YES ____ NO ____

8.6.1 **CPR Seat Cabinet – BIDDER EXEMPTION**

A single cabinet shall be mounted at the ceiling level directly over the entire length of the CPR seat. It shall have a "flip-up" Plexiglas door. There must be a minimum of 43" from the bottom of this cabinet to the top of the CPR seat cushion.

BIDDER EXEMPTION COMPLY? YES ____ NO ____

8.6.1.2 **SEAT, CPR – BIDDER EXEMPTION**

A sidewall seat will be mounted in the center of the left wall with lift up seat for storage below. This seat will be comprised of three molded/contoured seamless vacuum formed vinyl cushions. A seat belt shall be provided for attendant safety. Cushions shall be vacuum-formed seamless. One inch Cushions shall be installed on three sides of head area.

BIDDER EXEMPTION COMPLY? YES ____ NO ____

9.1.0 **UPHOLSTERY – BIDDER EXEMPTION**

All door panels, seat cushions, and protective pads shall be constructed of fire-retardant foam, covered with minimum 40-ounce vinyl. All seat and back cushions in the patient compartment shall be vacuum-formed seamless.

BIDDER EXEMPTION COMPLY? YES ____ NO ____

9.2.0 **HEADLINER – BIDDER EXEMPTION**

The headliner shall be constructed of padded white vinyl in three sections, with the center section being removable to gain access to wiring.

BIDDER EXEMPTION COMPLY? YES ____ NO ____

9.3.0 **PANELING, INTERIOR – BIDDER EXEMPTION**

Exposed surfaces shall be mar, dent and scratch resistant. Walls shall be covered with high pressure Wilsonart laminate material.

BIDDER EXEMPTION COMPLY? YES _____ NO _____

9.4.0 **GRAB RAILS, OVERHEAD – NO EXCEPTIONS**

9.4.1 (2) Full-length stainless steel handicap style 1 1/2" diameter grab rails shall be installed on patient compartment ceiling. These rails shall be capable of supporting a minimum of 300 pounds each.

9.4.2 This Rail shall be treated with an Anti-Bacterial Coating.

NO EXCEPTIONS COMPLY? YES _____ NO _____

9.5.1 **GRAB HANDLES, DOORS – BIDDER EXEMPTION**

All entry doors will have a matching heavy duty stainless steel handicap style 1 1/2" "V" bar grab handle that will be securely mounted slightly below the window. These Bars shall be treated with Agion Anti-Bacterial Coating.

BIDDER EXEMPTION COMPLY? YES _____ NO _____

9.6.0 **STAINLESS STEEL WALL – BIDDER EXEMPTION**

The lower left aisle wall shall be .060 stainless steel from action shelf down to floor. The stainless steel shall be installed after the floor is in place and installed over the edge of the floor. This will eliminate the seam and possibility of fluid retention.

BIDDER EXEMPTION COMPLY? YES _____ NO _____

10.1.0 **PATIENT COT (INCLUDING SPARE COT) – NO EXCEPTIONS**

A Stryker Power Pro X-Frame Cot shall be included in the bidders spec. A customer provided list of cot options shall be provided in the appendix section of this bid spec. A second (spare) Stryker Power Pro X-Frame Cot shall also be included with identical specs and features as the primary cot. (Total of two (2) cots in this spec line item)

NO EXCEPTIONS COMPLY? YES _____ NO _____

10.2.0 **COT MOUNT – NO EXCEPTIONS**

An approved Stryker Performance-Load cot fastener shall be supplied and installed by the bidder. (Revision 8 compliant)

NO EXCEPTIONS COMPLY? YES _____ NO _____

11.1.0 **INSULATION – BIDDER EXEMPTION**

The entire patient compartment, walls and ceiling, shall be blanketed with two layers of reflectix insulation. In between the two layers of reflectix insulation shall be a 2" polystyrene insulation to provide exceptional insulation and sound deadening qualities. To make certain the insulation stays in place, all insulation in the vertical walls is to be glued in place.

BIDDER EXEMPTION COMPLY? YES _____ NO _____

11.2.0 All exterior compartment and patient compartment entry doors shall be insulated with a single layer of R-14.5 reflectix insulation. Additionally there shall be a single layer of 2" polystyrene insulation installed in each door.

BIDDER EXEMPTION COMPLY? YES ____ NO ____

12.1.0 CLIMATE CONTROL – BIDDER EXEMPTION

Rear climate control shall be floor mounted in driver side bulkhead cabinet to shorten refrigerant and anti-freeze hoses and eliminate vertical circulation. Condensation from high humid conditions shall drain directly through floor. Air intake shall be at floor level; output shall be at ceiling level with return air at floor level for increased airflow. Return air shall be filtered.

BIDDER EXEMPTION COMPLY? YES ____ NO ____

12.2.0 The unit shall be a Pro-Air with 32,000 BTU cooling capacity and a 35,000 BTU heating capacity. The blower motor shall have permanent magnets and be capable of delivering 630 CFM of airflow. It must be removable without removing entire heat/cool unit and without disconnection of any coolant lines.

BIDDER EXEMPTION COMPLY? YES ____ NO ____

12.3.0 An multiplex integrated thermostat shall control both heating and cooling with 3-speed fan control. The thermostat shall be located on the action wall.

BIDDER EXEMPTION COMPLY? YES ____ NO ____

13.0.0 OXYGEN OUTLETS – BIDDER EXEMPTION

13.1.0 Oxygen system shall be plumbed with conductive hose from oxygen compartment to two Puritan-Bennett Ohio style oxygen outlets in the action area, and a third over the cot mounted in the ceiling. A fourth outlet shall be installed above the check-out timer on the passenger side interior wall under the left side of the overhead compartment.

BIDDER EXEMPTION COMPLY? YES ____ NO ____

13.2.0 Manufacturer of the Oxygen system is **BIDDER EXEMPT**, however the INSTALLED LOCATIONS of the oxygen outlets is **NO EXCEPTION**.

BIDDER EXEMPTION COMPLY? YES ____ NO ____

14.0 EXTERIOR BODY

14.1.0 REAR WHEEL WELL TRIM – BIDDER EXEMPTION

The rear wheel wells shall be trimmed with polished Stainless Steel Fenderettes that shall be attached to the body with stainless steel fasteners. There shall be a gasket placed between the aluminum body and the stainless steel fenderette for isolation of the dissimilar metals.

BIDDER EXEMPTION COMPLY? YES ____ NO ____

14.2.0 RUB RAILS – BIDDER EXEMPTION

There shall be bolt on clear anodized extrusion rub rails with a wall thickness of (.187). They shall run the full length of the body and be mounted at the base of each side of each side of the body. The rub rails shall be spaced ¼ inch from the body with Delrin spacers.

BIDDER EXEMPTION COMPLY? YES ____ NO ____

14.3.0 **BUMPER, REAR STEP – BIDDER EXEMPTION**

The rear step assembly shall be constructed of 1 3/4" X 1 3/4" tubular steel frame bolted to the chassis frame. The center section shall be non-skid grip strut, which will allow mud and snow to fall through the step. The ends shall be constructed of diamond plate end caps with 18" X 4" X 4" heavy-duty rubber dock bumpers. A non-flip up style rear step is preferred.

BIDDER EXEMPTION COMPLY? YES ____ NO ____

14.4.0 **DOOR STEP, SIDE – BIDDER EXEMPTION**

The side doorstep shall be formed of aluminum diamond tread and shall be flush sweep out style. Antiskid tape, 2 inch wide, is to be laid the full width of the step just inside the entry door. Additionally there shall be a formed 3-inch, full width stainless steel floor protection strip installed over the flooring at the top of the step. An LED step well light is to be installed on the forward vertical wall of the step well with the wiring to be pulled through the backside of the step well. The lower side of the step well shall be covered with Hush Mat to reduce road noise.

BIDDER EXEMPTION COMPLY? YES ____ NO ____

14.5.0 **STONE SHIELDS – NO EXCEPTIONS**

Diamond plate stone shields shall be installed on the front edge of the module body directly behind the cab at skirt level. These shields shall extend up the front of the box approximately 16 inches.

NO EXCEPTIONS COMPLY? YES ____ NO ____

15.0.0 **EXTERIOR COMPARTMENT CONFIGURATION**

NOTE: See Drawings for Compartment Location and Dimensions. Compartments shall be bid as close to customer specs and drawings as possible. It is understood by the customer that there may be some measurement variances by the manufacturer

15.1.0 **#1 OXYGEN COMPARTMENT (D1)**

The left front (street side) exterior compartment shall contain a "Zico" nylon triple collar bracket to house one "M" size oxygen cylinder. The O2 tank is to be stored in the aft side of the compartment. There shall be an interior access door to allow the attendant to turn the oxygen tank valve on/off from the patient compartment. A separate O2 compartment light shall be provided for the purpose of viewing the tank O2 gauge and be switched on/off from the action panel. A wrench is to be provided for changing the tank regulator. This wrench is to be secured in the compartment with a cable and mounted to the compartment wall when not being used.

NO EXCEPTIONS COMPLY? YES ____ NO ____

15.1.1 This compartment shall have an aluminum divider located between the O2 tank and the storage side of the compartment. A shelf is to be installed from the divider to the compartment aft wall above the O2 bottle.

NO EXCEPTIONS COMPLY? YES ____ NO ____

15.1.2 The forward side of the compartment is to provide storage for and shall have rubber “nerf” strips, two (2) on the floor and two (2) on the back wall of the compartment.

NO EXCEPTIONS COMPLY? YES ____ NO ____

15.1.3 On the forward wall of the compartment there shall be a removable panel approximately 8” square in size located opposite of the shoreline plug. This panel, when removed, provides access to the shoreline plug when service or replacement is required.

NO EXCEPTIONS COMPLY? YES ____ NO ____

15.1.4 Compartment Dimensions: 18” wide x 86 3/8” high

BIDDER EXEMPTION COMPLY? YES ____ NO ____

15.2.0 #2 GENERAL STORAGE COMPARTMENT (D2)

15.2.1 This compartment shall be located street side between the #1 compartment and the left side drive wheels and is to be used for general storage. There is to be a double door on this compartment.

NO EXCEPTIONS COMPLY? YES ____ NO ____

15.2.2 Compartment Dimensions: 49” wide x 40” high

BIDDER EXEMPTION COMPLY? YES ____ NO ____

15.3.0 #3 SCBA / TURN-OUT GEAR COMPARTMENT (D3)

15.3.1 The left rear street side exterior compartment shall be for the storage of two (2) SCBA’s, customer supplied SCBA mounting brackets, two (2) full sets of turnout gear and (2) LED handlights. (1) 12VDC, 12gauge copper stranded, chassis key hot power and chassis ground wire shall be installed, with approximately 48” of excess cable, crimp terminated in this compartment. This power feed shall be fused for 15 amps and shall be wired chassis 12VDC battery hot. The inner back wall of this compartment shall be reinforced to provide provisions for mounting SCBA brackets. Two (2) doors for this compartment. Compartment doors must open outward to 130 degrees.

NO EXCEPTIONS COMPLY? YES ____ NO ____

15.3.2 Compartment Dimensions: 37” wide x 68” high x 20.75” deep

BIDDER EXEMPTION COMPLY? YES ____ NO ____

15.4.0 #5 CURBSIDE BACKBOARD COMPARTMENT (P2)

15.4.1 The right rear curb side exterior compartment shall be a single door full height vertical compartment for the purpose of storing a minimum of three (3) backboards, a stairchair and miscellaneous other related equipment. The compartment is to be divided equally with an aluminum divider.

NO EXCEPTIONS COMPLY? YES ____ NO ____

15.4.2 There shall be a shelf located on the forward side of the divider approximately 5' above the floor.

NO EXCEPTIONS COMPLY? YES ____ NO ____

15.4.3 There shall be a total of (3) adjustable shelves on the forward side of the divider.

NO EXCEPTIONS COMPLY? YES ____ NO ____

15.4.4 A minimum of (2) straps shall ensure the backboards remain in place at all times when not in use and shall have buckles capable of rapid release.

NO EXCEPTIONS COMPLY? YES ____ NO ____

15.4.5 A Stryker stair chair mounting bracket shall be mounted to the forward side of the divider in this compartment.

NO EXCEPTIONS COMPLY? YES ____ NO ____

15.4.6 Compartment Dimensions: 26" wide x 86 3/8" high

BIDDER EXEMPTION COMPLY? YES ____ NO ____

15.5.0 #6 ALS IN/OUT ACCESS (P1)

15.5.1 There shall be a single full-length door located at the right front (curbside) allowing for In/Out access to the ALS interior cabinet.

NO EXCEPTIONS COMPLY? YES ____ NO ____

15.5.2 Compartment Dimensions: 20" wide x 70" high

BIDDER EXEMPTION COMPLY? YES ____ NO ____

16.0 BODY FINISH

16.1.0 PAINTING PROCEDURE

The vehicle paint, lettering and decal work shall be identical to existing units of the customer. An on-site visit by the bidder is recommended to ensure compliance. An extensive 6-step painting process is to be followed and strictly adhered to as follows:

16.2.0 Prior to paint all doors, chrome trim, lights, handles, steps, and all other attached equipment shall be removed to assure the paint process covers the entire body. No Weather-stripping will be attached to the body during the paint process.

BIDDER EXEMPTION COMPLY? YES ____ NO ____

16.3.0 The entire outside of the body shall be sanded with a minimum of 180 grit sandpaper and cleaned and deburred of all rough edges. The entire body shall then be wiped clean with PPG DX436 wax and grease remover prior to painting.

BIDDER EXEMPTION COMPLY? YES ____ NO ____

16.4.0 The body shall then be coated with (1) coat of PPG Delfleet Evolution F3993 Epoxy Primer followed by (2) coats of PPG Delfleet Evolution F3975 Urethane Primer. Once the primer has been applied the entire unit shall be baked at 150 degrees for a minimum of 30 minutes. The primer shall then be sanded prior to the application of the topcoat.

BIDDER EXEMPTION COMPLY? YES _____ NO _____

16.5.0 Once the application of the primer has been completed, a topcoat consisting of (2) coats of PPG Delfleet Evolution FBC Color Coat is applied followed by (2) coats of PPG Delfleet Evolution F3921 Clear coat for a durable long lasting high gloss finish. The entire unit shall then be baked a second time at 160 degrees for a minimum of (45) minutes.

BIDDER EXEMPTION COMPLY? YES _____ NO _____

16.6.0 After the body paint procedure is completed a band shall be applied at midline forming a continuous band around the vehicle. This band is to be painted with (2) coats of PPG Delfleet Evolution FBC Color Coat followed by (2) coats of PPG Delfleet Evolution F3921 Clear Coat.

BIDDER EXEMPTION COMPLY? YES _____ NO _____

16.7.0 The final step shall then be to apply Rubberized undercoating to the underside of the cab and the body in strict adherence to Ford QVM guidelines and the KKK-1822- E Specification just prior to delivery.

NO EXCEPTION COMPLY? YES _____ NO _____

16.8.0 Warranty shall be a full 5-year / 100,000 mile **NON-PRORATED** Modular Paint Warranty.

BIDDER EXCEMPTION COMPLY? YES _____ NO _____

17.1.0 DECALS, STAR-OF LIFE

There shall be DOT approved decals provided as follows;

- 2) 6" Star-Of-Life
- 2) 12" Star-Of-Life
- 2) 16" Star-Of-Life
- 1) 36" Star-Of-Life
- 1) 4" Mirror-Image "AMBULANCE"
- 3) 6" AMBULANCE"

NOTE: This spec shall be BIDDER EXCEMPTION, however MUST meet ALL KKK REQUIREMENTS.

BIDDER EXCEMPTION COMPLY? YES _____ NO _____

18.0 PAYLOAD

18.1.0 PAYLOAD

There shall be a minimum of 3,650 lbs. of usable payload. Weight determination shall be made with standard unit, full complement of fuel, fluids and spare tire. Any optional equipment shall be deducted from payload.

NO EXCEPTIONS COMPLY? YES _____ NO _____

19.0 MISCELLANEOUS EQUIPMENT

19.1.0 DECALS, NO SMOKING & OXYGEN EQUIPPED

There shall be two NO SMOKING / OXYGEN EQUIPPED signs, one each in the cab and one in the patient compartment.

NO EXCEPTIONS COMPLY? YES ____ NO ____

19.2.0 I.V. HOLDERS

There shall be two recessed, swing-up dual I.V. bag holders mounted in patient compartment headliner. (see Interior Ceiling drawing for location details). The holders shall be Cast Products # IV-2009 (KKK-1822-F Approved).

BIDDER EXEMPTION COMPLY? YES ____ NO ____

19.3.0 ANTENNA PRE-WIRE

One (1) RG-58/59 pre-wired antenna coaxial cable shall be installed from the roof of the cab to the main electrical compartment within the patient compartment. This cable shall not interfere with any SRS Airbag System within the cab.

NO EXCEPTIONS COMPLY? YES ____ NO ____

19.4.0 WIRING SCHEMATIC

There shall be a complete set of **SPECIFIC** wiring schematics showing all circuits, including optional equipment included with the owner's manuals. These as-built schematics shall be in electronic file format and shall be provided on a USB style "thumb drive". The City of Princeton Fleet Services Manager shall be provided full diagnostic and adjustment abilities to all electrical aspects of the chassis and module.

NO EXCEPTIONS COMPLY? YES ____ NO ____

19.5.0 The bidder shall include two (2) rechargeable Streamlight Vulcan handlights LED with 12VDC charging capability shipped loose.

NO EXCEPTIONS COMPLY?..... YES ____ NO ____

20.0 WARRANTY

20.1.0 WARRANTY

Three year / 36,000 mile Product Conversion Warranty.
Six-year / 72,000 mile Electrical System Warranty.
Five-year / 100,000 mile **NON-PRORATED** Modular Paint Warranty.
LIFETIME Modular Body Structure Warranty.

There shall be no pro-rating allowed for any portion of the above listed warranties.

BIDDER EXEMPTION COMPLY? YES ____ NO ____

21.0 REQUIREMENTS OF THE MANUFACTURER

21.1.0 KKK-A-1822-F CERTIFICATION

This unit shall meet all KKK-A-1822 - F specifications and the manufacturer shall have current documentation of compliance with all KKK-A-1882-F standards.

NO EXCEPTIONS COMPLY? YES ____ NO ____

21.2.0 FORD QVM PROGRAM

This unit shall meet all Ford QVM Program requirements and the manufacturer shall be a current member in good standing of the Ford QVM Program.

NO EXCEPTIONS COMPLY? YES ____ NO ____

21.3.0 NTEA / AMD MEMBERSHIP

The manufacturer shall be a current member in good standing of the Ambulance Manufacturers Division (AMD) of the National Truck & Equipment Association (NTEA). The unit shall be built in compliance with all AMD "Standards".

NO EXCEPTIONS COMPLY? YES ____ NO ____

21.4.0 REMountING AND REFURBISHING

The manufacturer must be capable of remounting and / or refurbishing used units. The facilities for such purpose shall be located at the manufacturer's primary location. The subcontracting of remounting and refurbishing is strictly prohibited.

NO EXCEPTIONS COMPLY? YES ____ NO ____

21.5.0 FORD POOL ACCOUNT PROGRAM

The manufacturer shall be a current member in good standing of the Ford Pool Account Program.

NO EXCEPTIONS COMPLY? YES ____ NO ____

22.0.0 PRE-DELIVERY FACTORY INSPECTION

A pre-delivery inspection trip shall be provided by the bidder for (2) representatives of the customer. The inspection trip shall take place during the latter stages of the manufacturing process. The trip shall include transportation and lodging for a one day / one night stay. A trip requiring travel of more than 350 miles shall be via commercial air carrier.

BIDDER EXEMPTION COMPLY? YES ____ NO ____

23.0.0 CUSTOMER TRADE-IN VEHICLE

The customer trade-in for this spec package shall consist of the following specs. Pictures may be sent to the bidder by request to the customer. The trade-in ambulance may be viewed at the Princeton Fire Department, 2 S Main St, Princeton, IL 61356.

Trade-In Specs: 2007 International / Medtec Ambulance
 4300 SBA LP 4x2
 170" Medtec Module
 10055 Engine Hours
 90854 Miles

APPENDICIES

10.3.0 STRYKER POWER PRO X-Frame Cot and PERFORMANCE LOAD MOUNT ACCESSORIES LIST

1 Year parts, labor and travel
Power Pro X-Frame Standard Components
Domestic Boxed Shipped Option
Dual Wheel Locks
J-Hook
No Power-Load Capability
Standard Side Rail
G-Rated Restraint Package
2 Stage IV Pole, Patient Right
No Runner / HE O2
G-Rated Bolster Mattress
Permanent Head End Oxygen Bottle Holder
Right Hand Release Handle
3-Yr X-Frame Warranty
Head-End Storage Flat
Base Storage Net
Smart Charger Mounting Bracket

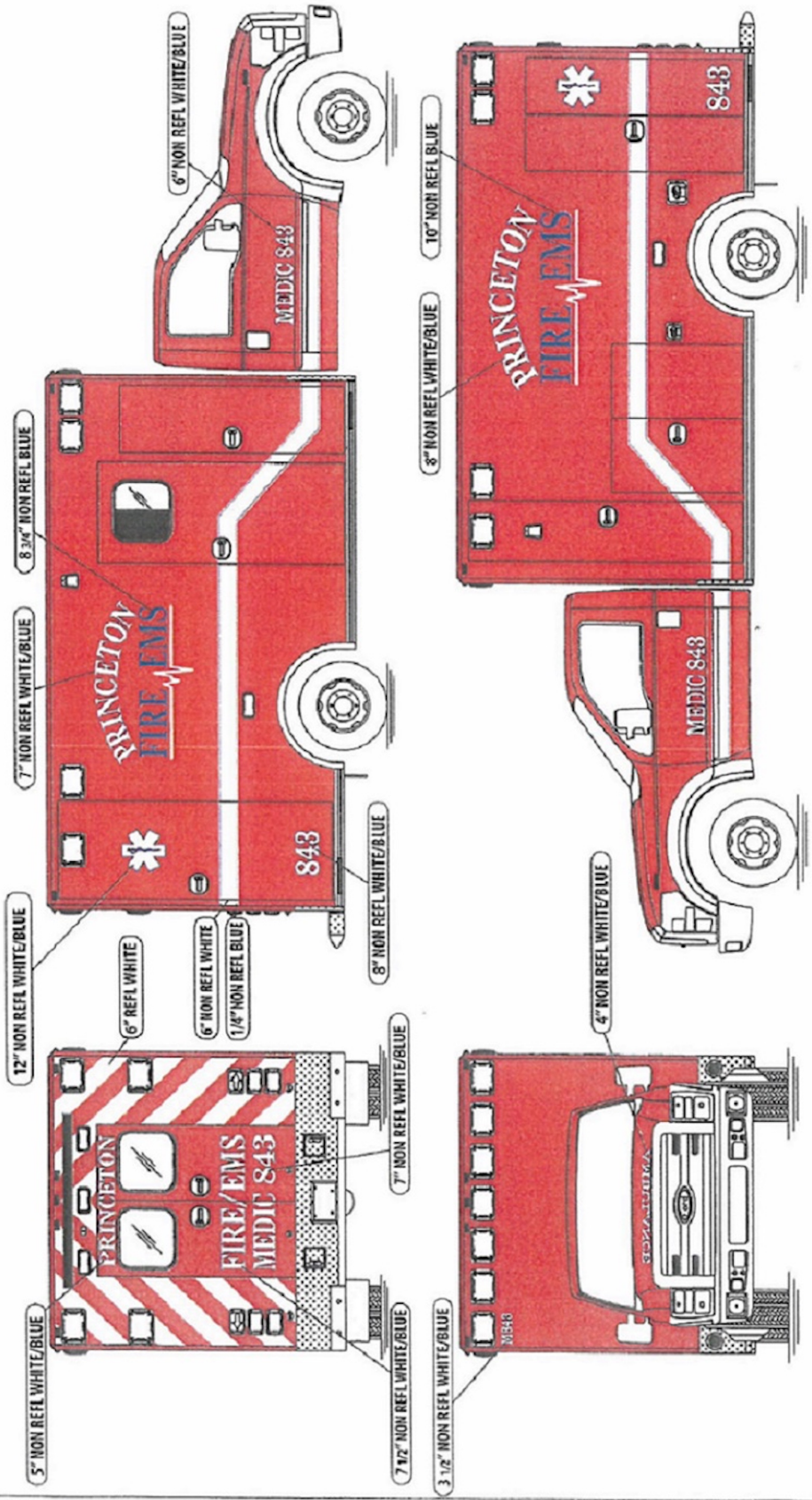

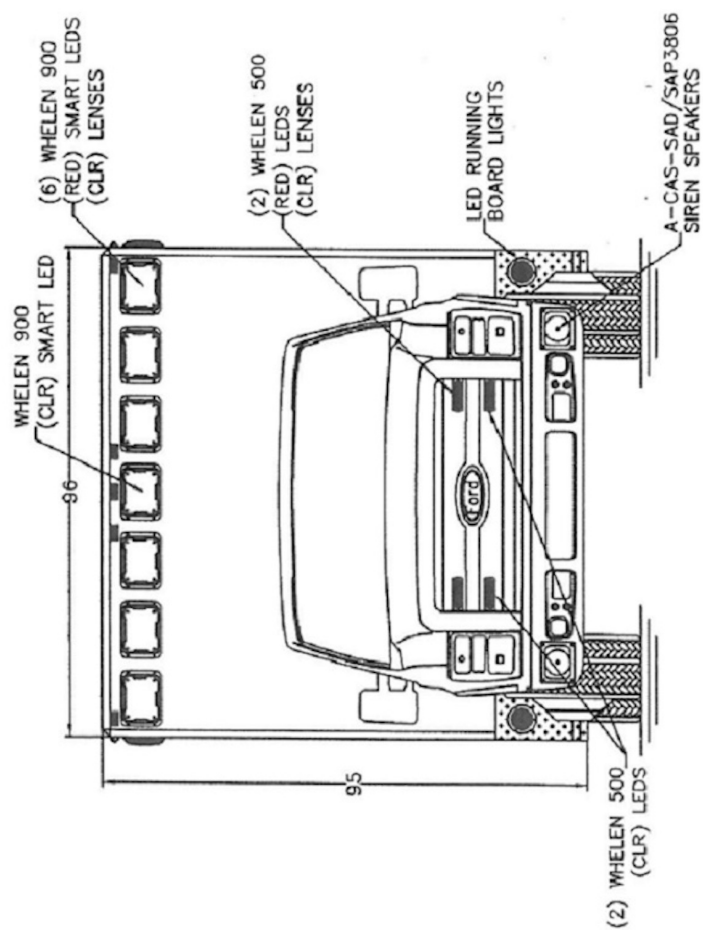
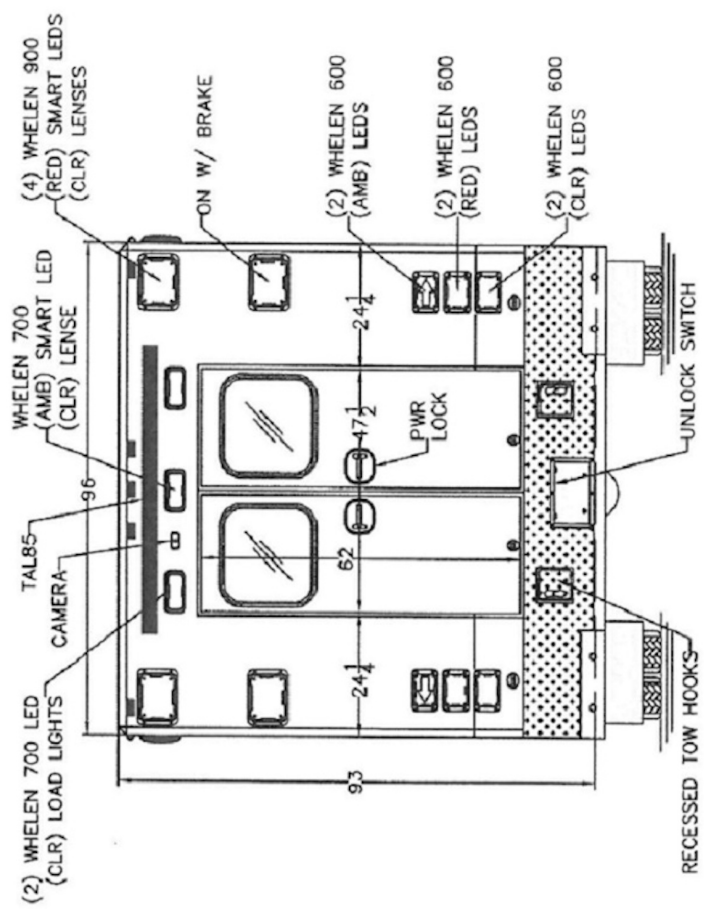

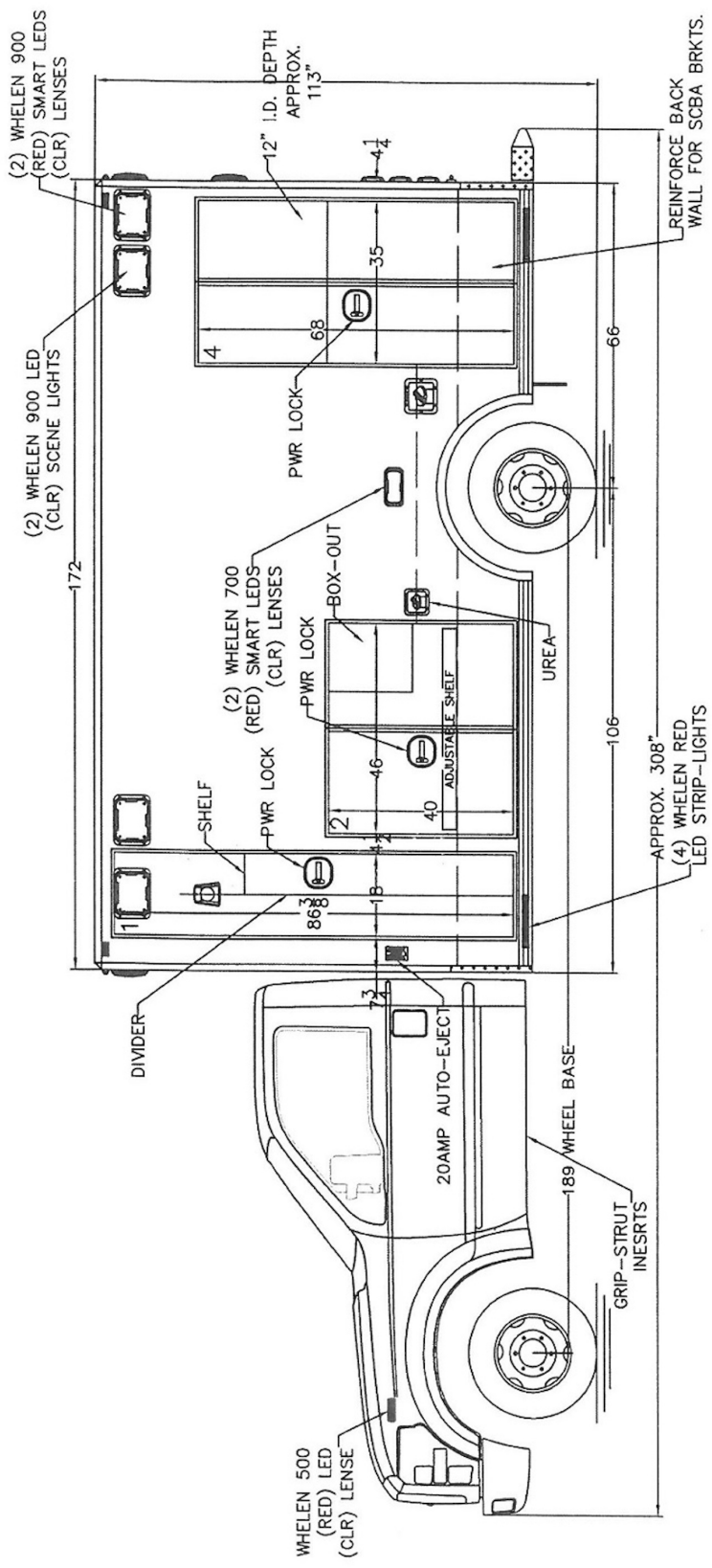

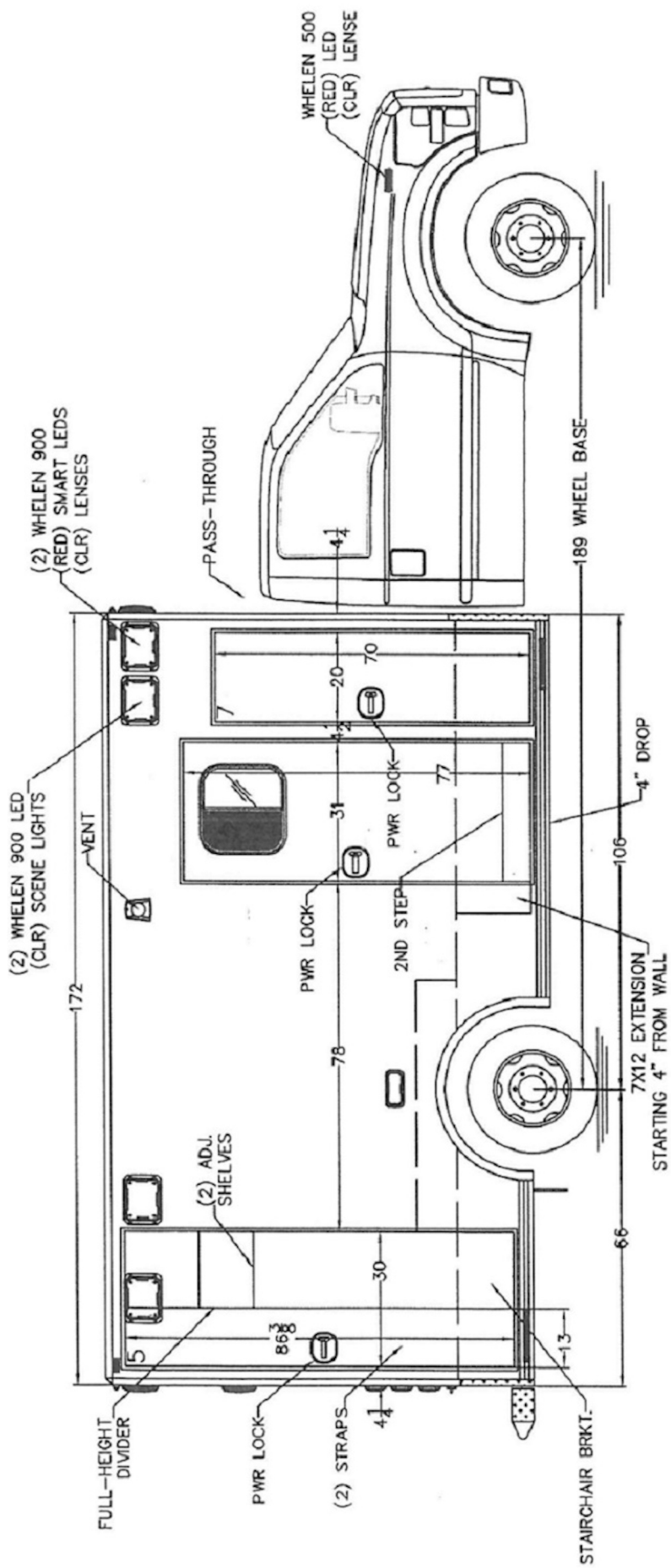

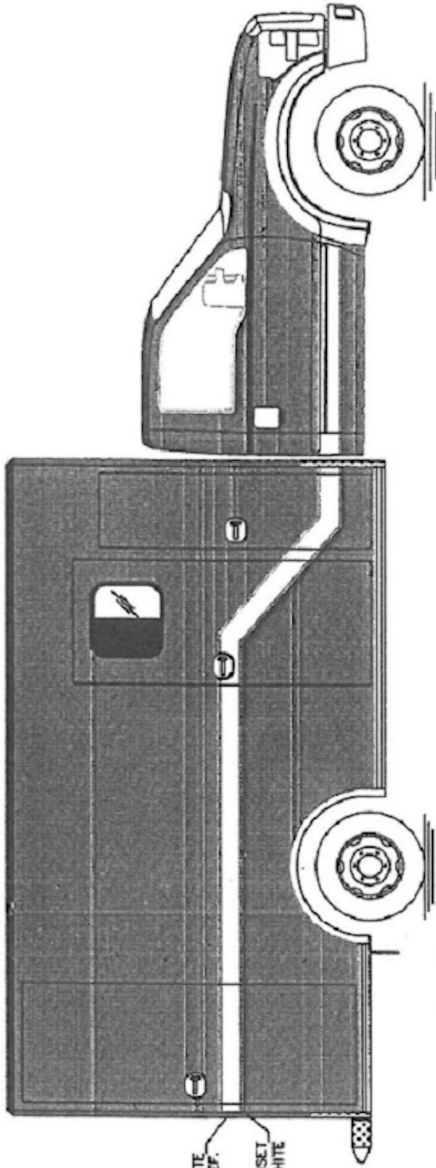

6" WHITE
6" RED
6" WHITE
NON-REF.
1/4" BLUE INSET
1/4" INTO WHITE

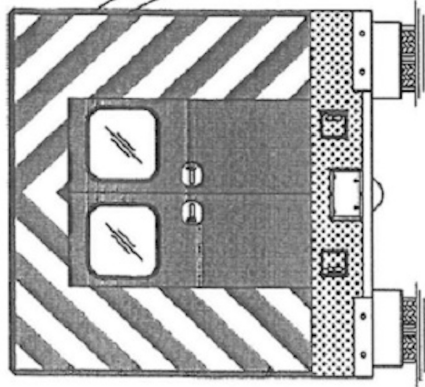

NOTES:
1.) PAINT BOX TO MATCH CAB RED PPG #926415.

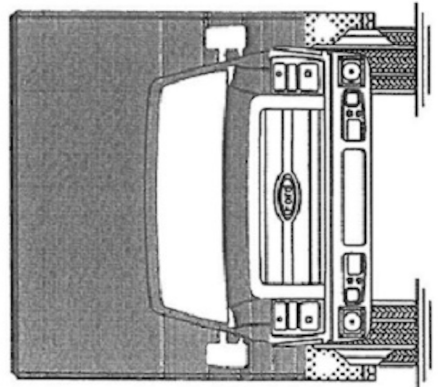
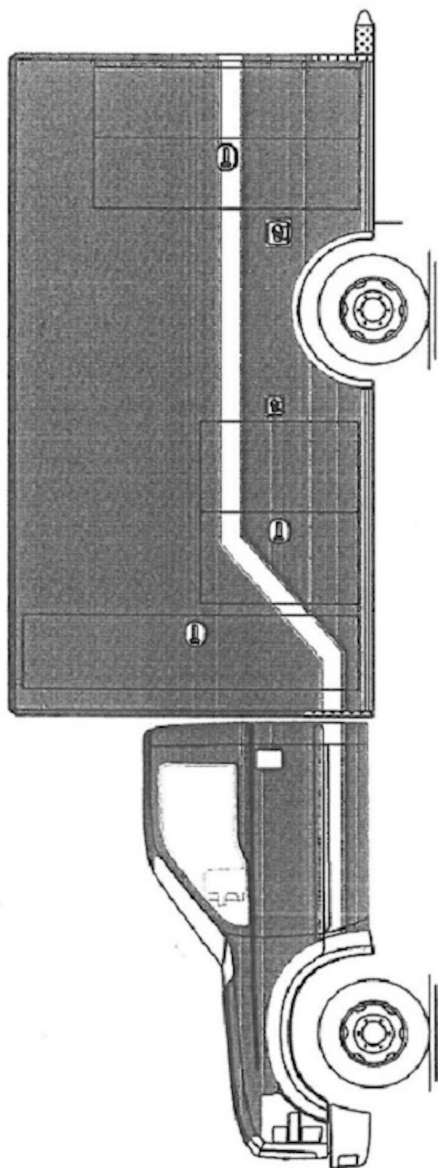

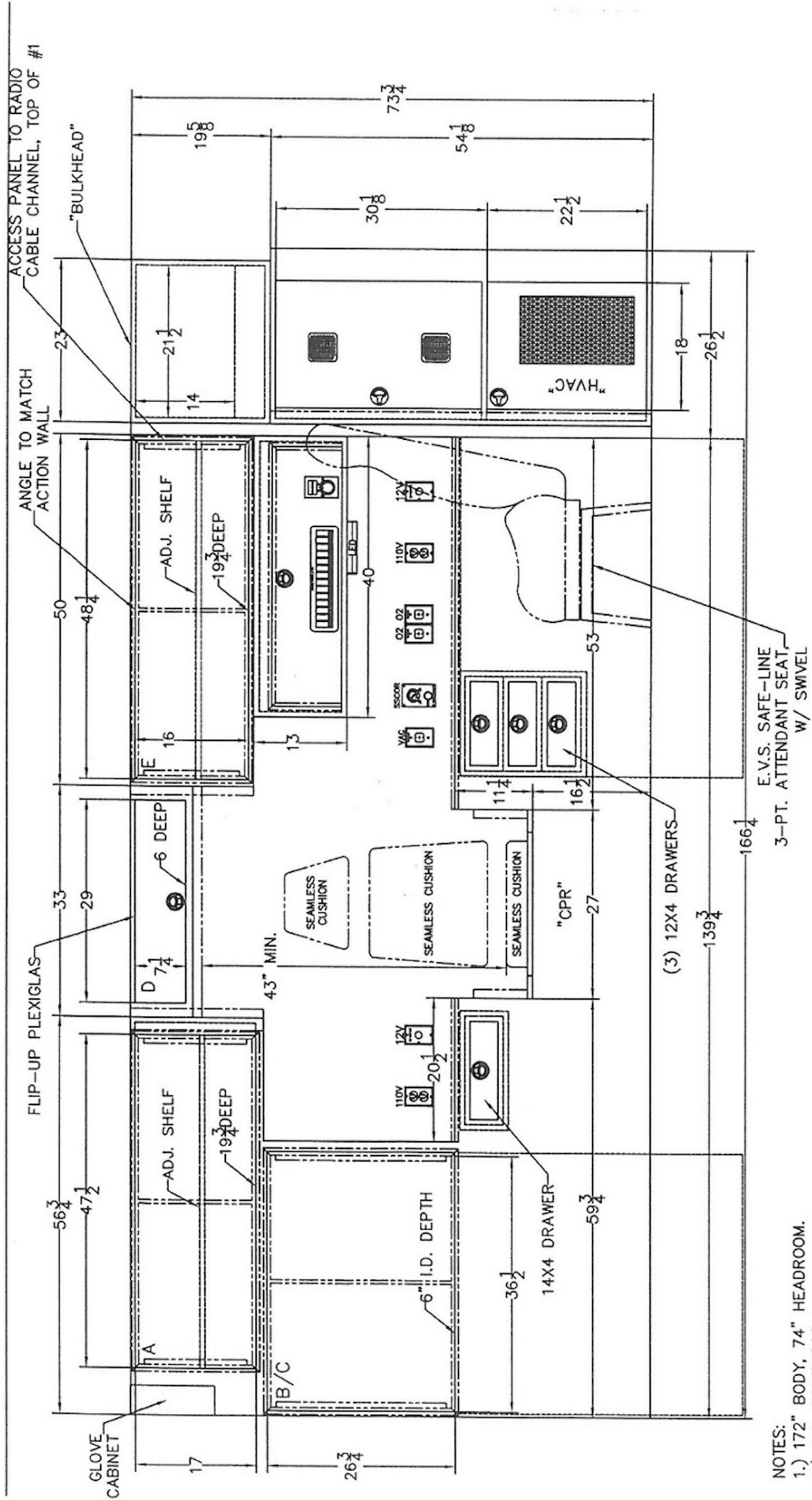

- NOTES:
- 1.) 172" BODY, 74" HEADROOM.
 - 2.) S.S. SOUTHCOS.

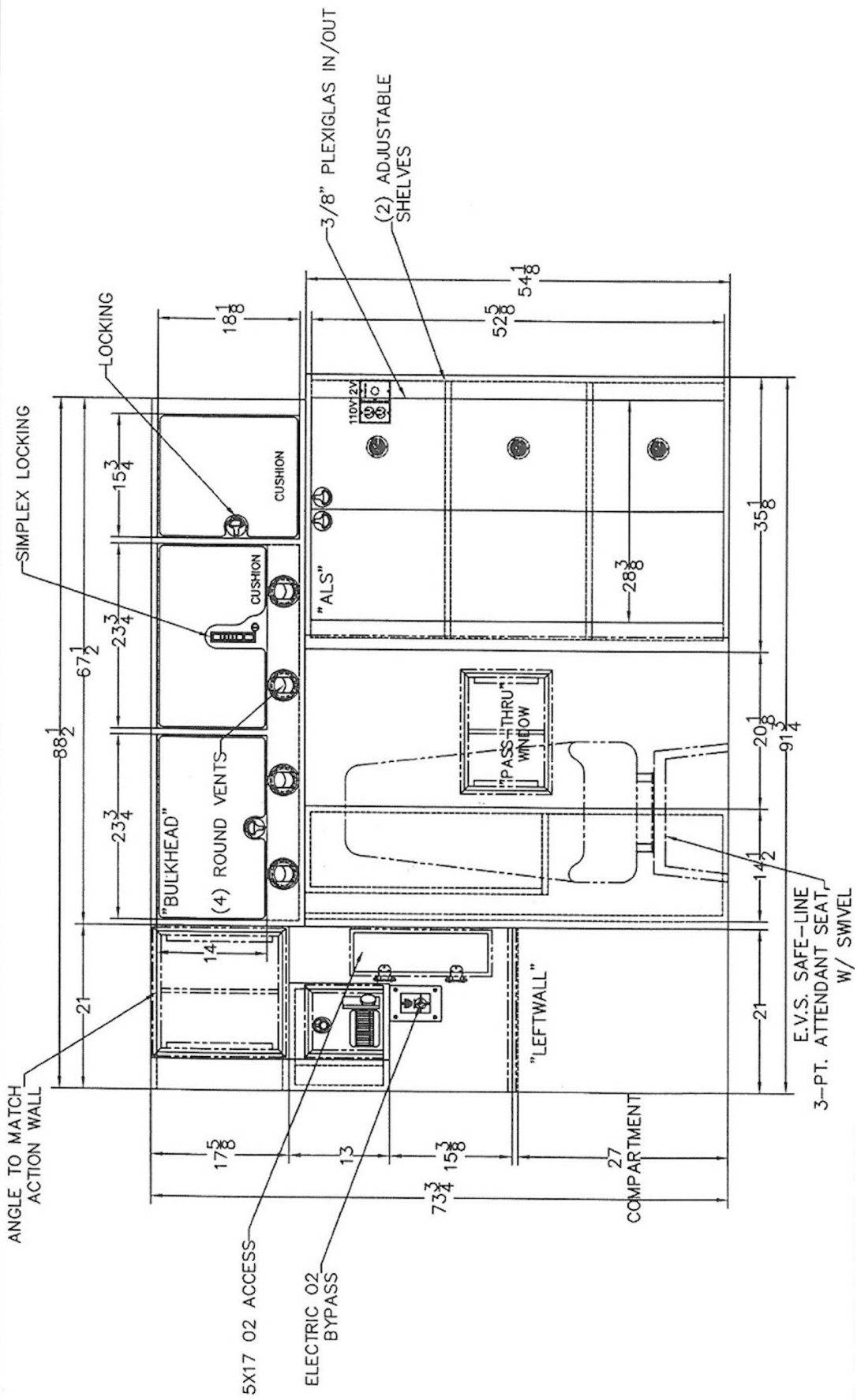

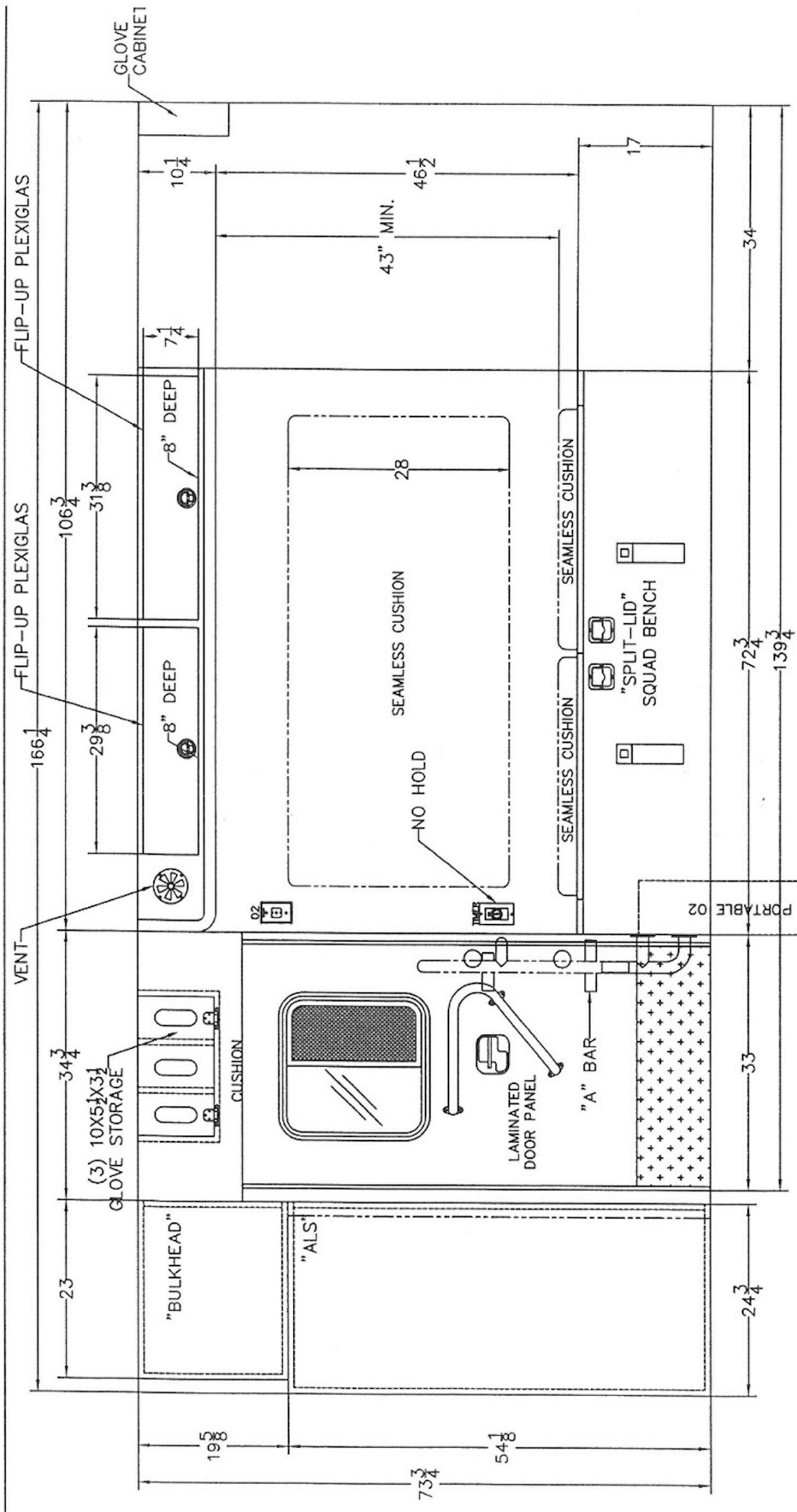

NOTES: THIS DRAWING IS NOT TO SCALE.
 CHARACTERISTICS AND DIMENSIONS OF FINISHED PRODUCT MAY VARY.

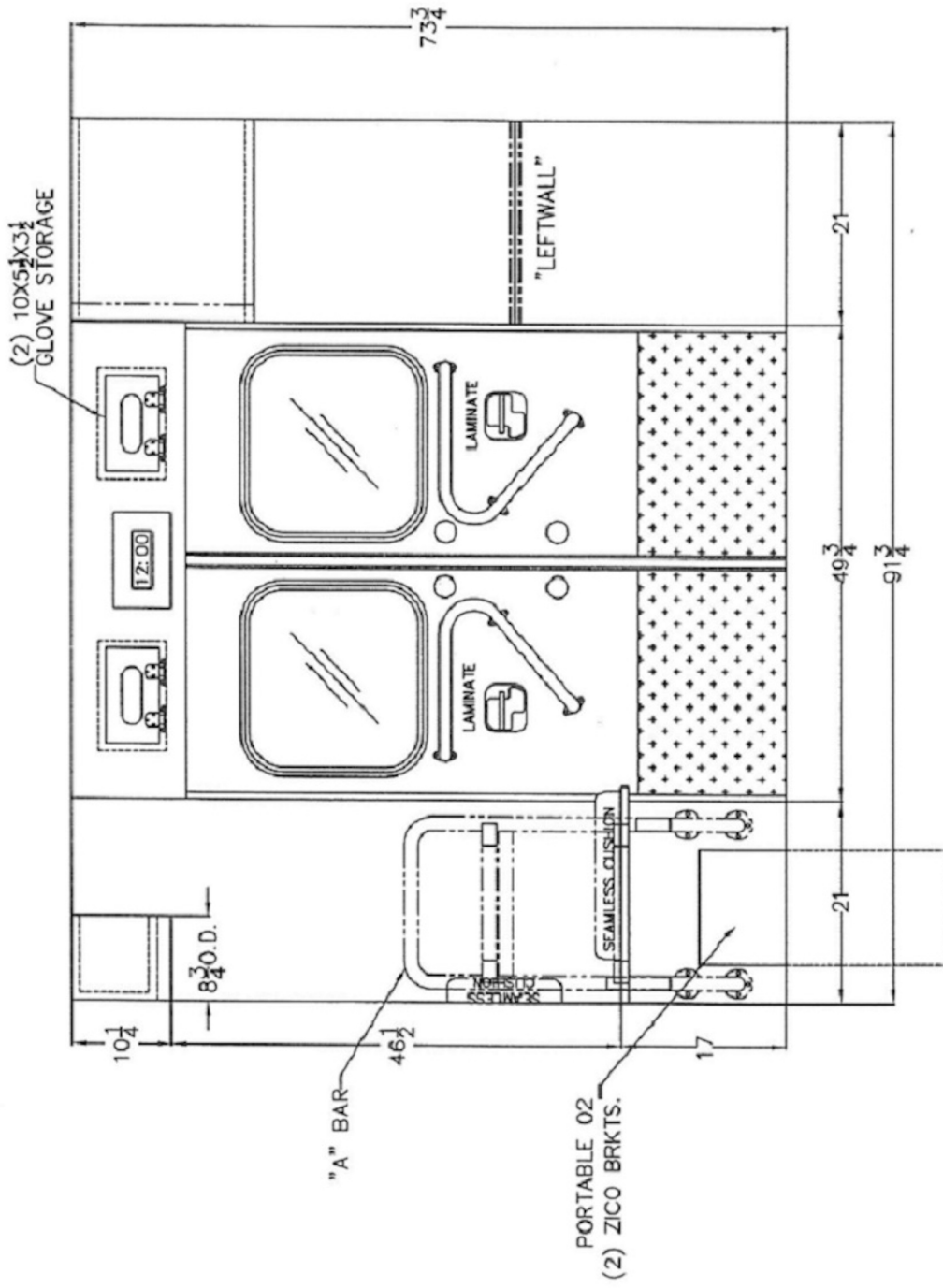

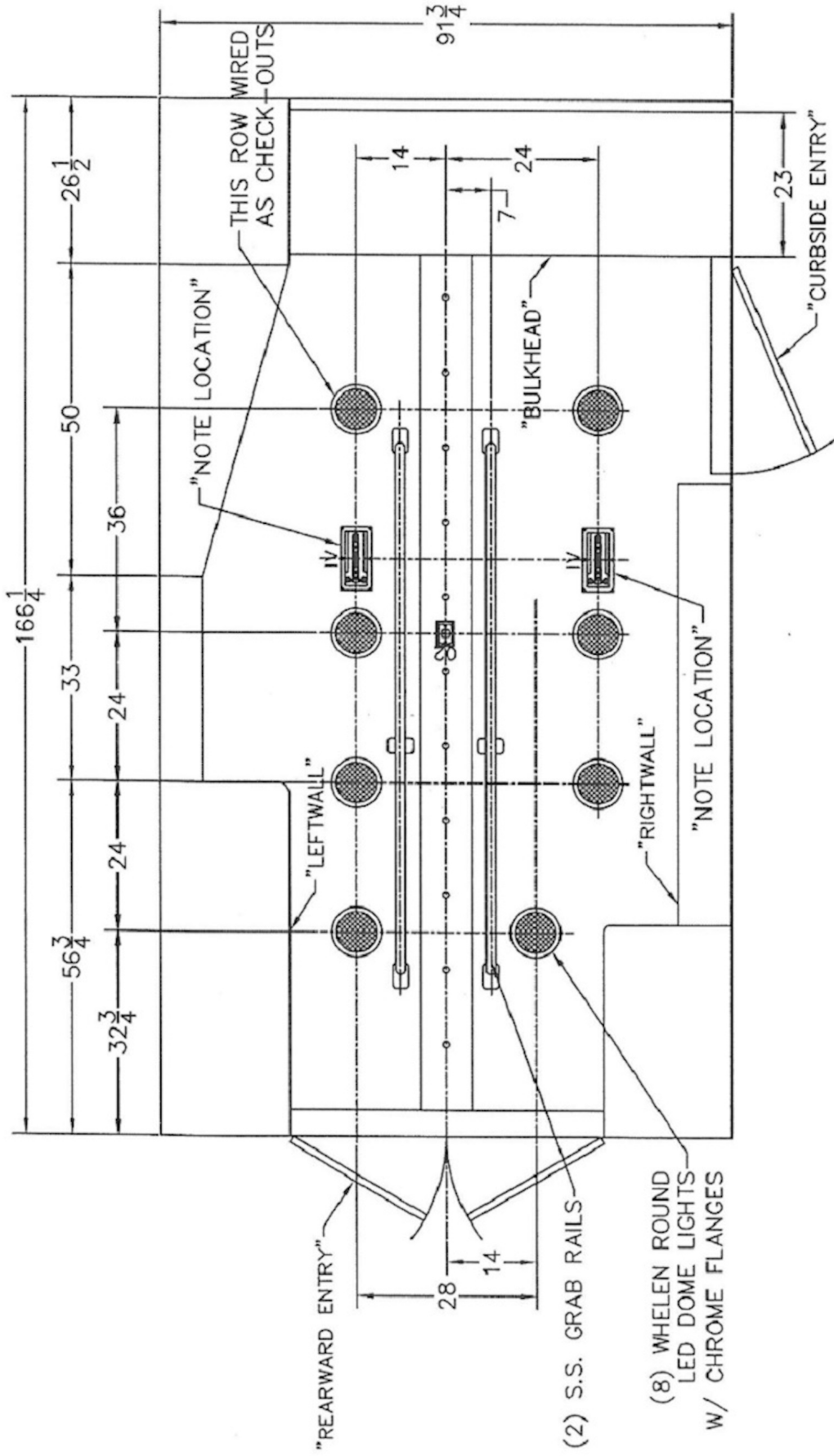

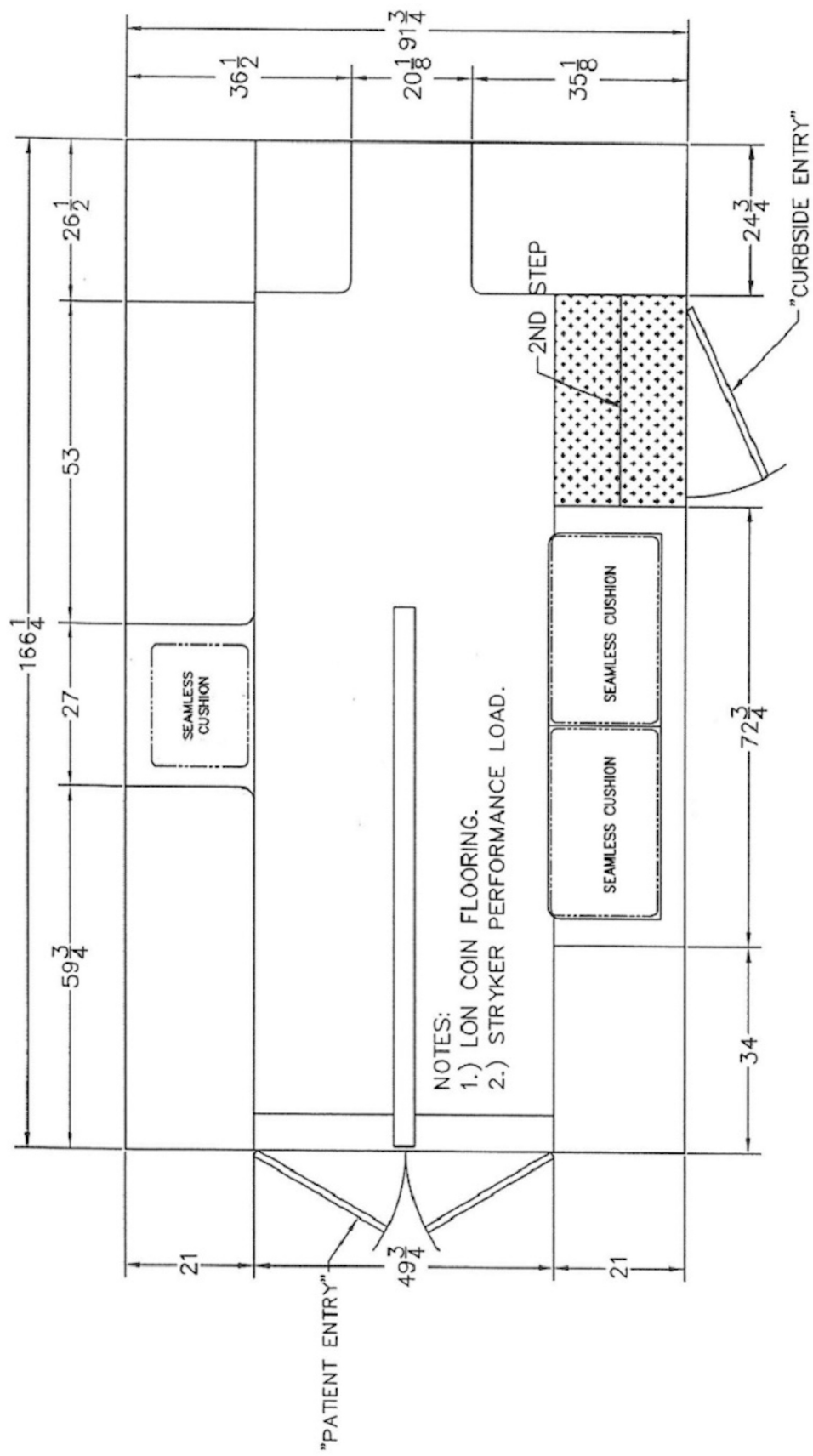

NOTES:
 1.) LON COIN FLOORING.
 2.) STRYKER PERFORMANCE LOAD.

